

0000 GENERAL

| CODE | SYMBOL | DESCRIPTION |
|------|--------|---|
| | | AREA TO BE DEMOLISHED UNLESS OTHERWISE NOTED |
| | | TO BE RELOCATED ELEMENTS TO KEEP |
| | | TO BE RETAINED ELEMENTS TO PRESERVE |
| | | SCOPE OF WORKS HORWOOD PLACE MAIN WORKS |
| | | SCOPE OF WORKS PHILLIP STREET EARLY WORKS |
| | | PHILLIP ST PEDESTRIAN CROSSING REMOVED REINSTATE KERB LINE AND ROAD |
| | | AWNING LINE BUILDING OVERHEAD |
| | | PROPOSED CONTOURS REFER IN CONJUNCTION WITH CIVIL ENG. |
| | | TW 25.5 TOP/BOTTOM OF WALL |
| | | EXISTING LEVEL REFER IN CONJUNCTION WITH CIVIL ENG. |
| | | FINISHED LEVEL REFER IN CONJUNCTION WITH CIVIL ENG. |
| | | FALL/GRADE REFER IN CONJUNCTION WITH CIVIL ENG. |
| | | PROPOSED STORMWATER SERVICES REFER ENG. DRAWINGS |
| | | EXISTING SERVICES PITS ELECTRICAL, DRAINAGE & TELECOMMUNICATIONS |
| | | EXISTING LIGHT POLE DEMOLISHED |
| | | EXISTING LIGHT POLE RELOCATED |
| | | EXISTING SERVICES FIRE HYDRANT LOCATION |
| | | EXISTING SIGNAGE POST DEMOLISHED |
| | | EXISTING SIGNAGE POST RELOCATED |
| | | SETOUT POINT STARTING POINT |

1000 PAVEMENTS & SURFACES

| CODE | SYMBOL | DESCRIPTION |
|-----------------------|--------|--|
| PAVEMENT TYPES | | |
| EP01 | | ASPHALT VEHICULAR EXISTING CARRIAGEWAY |
| EP02 | | EXISTING GRANITE PAVING PROTECT & RETAIN |
| EP03 | | EXISTING CONCRETE UNIT PAVING PROTECT & RETAIN |
| EP04 | | EXISTING CONCRETE UNIT PAVING PAVEMENT REMOVED & DOCUMENTATION BY POWERHOUSE |
| PV01 | | ASPHALT VEHICULAR NEW CARRIAGEWAY |
| PV02 | | GRANITE PAVER COP SPECIAL PLACE GRANITE PAVER |
| PV03 | | GRANITE PAVER PAVEMENT DOCUMENTATION BY POWERHOUSE LEVELS AS PER L_301 |
| PV04 | | GRANITE PAVER COP FEATURE STONE SETTS |
| DRAINAGE TYPES | | |
| | | EXISTING PIT STATUS TBC |
| PT01 | | STORMWATER PIT REFER CIVIL DOCUMENTATION |

2000 WALLS & EDGES

| CODE | SYMBOL | DESCRIPTION |
|-------------------|--------|--|
| KERB TYPES | | |
| DKB | | EXISTING KERB + GUTTER REMOVED |
| EKB | | EXISTING KERB RETAINED PROTECT & RETAIN |
| K01 | | CONCRETE KERB + GUTTER 150MM RAISED KERB |
| K02 | | CONCRETE KERB + GUTTER SLOTTED KERB |
| K03 | | CONCRETE KERB FLUSH KERB AT CROSSINGS |

3000 STAIRS & ANCILLARY

| CODE | SYMBOL | DESCRIPTION |
|----------------------|--------|--------------------|
| TACTILE TYPES | | |
| TC01 | | TACTILE INDICATORS |

ROAD INFRASTRUCTURE TYPES

| | |
|--|-----------------------------------|
| | ROAD MARKING REFER TO TRAFFIC ENG |
|--|-----------------------------------|

4000 RAILS & BALUSTRADES

| CODE | SYMBOL | DESCRIPTION |
|--------------------------------------|--------|--|
| N/A | | |
| 5000 FURNITURE & FIXTURES | | |
| N/A | | |
| FURNITURE TYPES | | |
| SE01 | | TIMBER BENCH COPC STANDARD BENCH |
| LIGHTING TYPES | | |
| L01A | | SMART POLE STREET LIGHT REFER TO ELEC. ENG |
| FIXTURE TYPES | | |
| FX01 | | BINS SINGLE 120L UNIT |

6000 WATER ELEMENTS

| CODE | SYMBOL | DESCRIPTION |
|---------------------------|--------|---|
| N/A | | |
| 7000 MISCELLANEOUS | | |
| N/A | | |
| STRUCTURE TYPES | | |
| SS01A | | CROSSING THRESHOLD PED REFER TO TRAFFIC ENG |
| SS01B | | CROSSING THRESHOLD CYCLE REFER TO TRAFFIC ENG |
| SIGNAGE TYPES | | |
| S01 | | PROPOSED SIGNAGE VEHICULAR ROAD SIGN TBC |

8000 SOFTWARES

| CODE | SYMBOL | DESCRIPTION |
|----------------------------|--------|--|
| SOIL PROFILE TYPES | | |
| SP01 | | NATIVE GARDEN SOIL MIX STABILISED |
| SP02 | | STRATA CELLS STRUCTURAL SOIL MODULES |
| TREE TYPES | | |
| | | EXISTING TREE RETAINED REFER ARBORIST REPORT |
| | | PROPOSED TREE REFER PLANTING PLANS/PLANTING SCHEDULE |
| MASS PLANTING TYPES | | |
| MP01 | | PHILLIP STREET PLANTING MIX |

| PROPOSED TREES | | | | | | | |
|----------------|------------------------|------------------|--------------|---------------------------|---------------------------|----------------|----------|
| ID | Latin Name | Common Name | Growth Habit | Approximate Mature Height | Approximate Mature Spread | Scheduled Size | Quantity |
| Ze | <i>Zelkova serrata</i> | Japanese Zelkova | Irregular | 15.0 - 35.0M | 12.0M | 400L | 2 |
| | | | | | | Total: | 2 |

| MP01 - PHILLIP STREET PLANTING MIX | | | | | | | | | | |
|------------------------------------|--|--|--------------|---------------------------|---------------------------|----------------|---------------------------|-----------------------|----------|--|
| Total Area | 84 m2 | | | | | | | | | |
| ID | Latin Name | Common Name | Growth Habit | Approximate Mature Height | Approximate Mature Spread | Scheduled Size | Planting Density (per/m2) | Percentage of Mix (%) | Quantity | |
| DiCa | <i>Dianella caerulea</i> | Paroo Lily, Blue Flax-lily | Grass | 0.45 - 0.6m | 0.3 - 0.6m | 200mm | 7 | 14.3 | 56 | |
| GrFA | <i>Grevillea rhyolitica x juniperina</i> | Grevillea 'Flat Az' | Groundcover | 0.3m | 0.35m | 200mm | 7 | 14.3 | 56 | |
| HaVi | <i>Hardenbergia violacea</i> | Purple Twining-pea, False Sarsaparilla | Climber | 0.75 - 0.9m | 1.2 - 2.0m | 200mm | 7 | 14.3 | 56 | |
| HePe | <i>Helichrysum petiolare</i> | *Everlasting, Licorice Plant* | Shrub | 0.30 - 0.45m | 0.6 - 0.9m | 200mm | 7 | 14.3 | 56 | |
| HiSc | <i>Hibbertia scandens</i> | Golden Guinea Flower, Snake Vine | Climber | 0.0 - 0.3m | 3.5 - 6m | 200mm | 7 | 14.3 | 56 | |
| LoTa | <i>Lomandra longifolia</i> 'Tanika' | Spiny-head mat rush, spiky-headed mat-rush, basket grass | Grass | 0.45 - 0.6m | 0.6 - 0.9m | 200mm | 7 | 14.3 | 56 | |
| RhIn | <i>Rhaphiolepis indica</i> | Snow Maiden | Shrub | 0.6 - 0.9m | 0.5m | 200mm | 7 | 14.3 | 56 | |
| | | | | | | | 0 | 0 | 525 | |

NOTE: FINAL QUANTITIES AND SELECTION PENDING AVAILABILITY

| PROPOSED TREES | | | | | | | |
|----------------|--------------------------|-----------------------------------|--------------|---------------------------|---------------------------|----------------|-----------|
| ID | Latin Name | Common Name | Growth Habit | Approximate Mature Height | Approximate Mature Spread | Scheduled Size | Quantity |
| | | | | | | | 0 |
| HymFl | Hymenosporum flavum | Native frangipani | Irregular | 20 - 25m | 1.2 - 2.0m | 400L | 15 |
| BraAc | Brachychiton acerifolius | Bottle Tree, Illawarra Flame Tree | Irregular | 25 - 30m | 3.5 - 6m | 400L | 5 |
| CoMac | Corymbia maculata | Spotted Gum | Irregular | over 30m | 10 - 15m | 400L | 17 |
| EuSid | Eucalyptus sideroxylon | Red Ironbark | Irregular | 25 - 30m | 3.5 - 6m | 200L | 3 |
| Total: | | | | | | | 44 |

| MP01 - BIOFILTRATION PLANTING MIX | | | | | | | | |
|-----------------------------------|------------------------------|---------------------------------------|--------------|---------------------------|---------------------------|----------------|---------------------------|------------|
| ID | Latin Name | Common Name | Growth Habit | Approximate Mature Height | Approximate Mature Spread | Scheduled Size | Planting Density (per/m2) | Quantity |
| FiNo | Ficinia nodosa | knobby club-rush | Ground Cover | 0.75 - 0.9m | 0.0 - 0.3m | 140mm | 7 | 90 |
| GaCl | Gahnia clarkei | Saw Sedge | Aquatic | 1.5 - 3m | 0.9 - 1.2m | 140mm | 7 | 90 |
| ImCy | Imperata cylindrica | Blady Grass | Grass | 0.9 - 1.5m | 0.3 - 0.6m | 140mm | 7 | 90 |
| LoTa | Lomandra longifolia 'Tanika' | Spiny-head mat rush, spiky-headed mat | Grass | 0.45 - 0.6m | 0.6 - 0.9m | 140mm | 7 | 90 |
| Total: | | | | | | | | 340 |

| MP01 - CIVIC LINK PLANTING MIX 01 | | | | | | | | | |
|-----------------------------------|------------------------------|--|--------------|---------------------------|---------------------------|----------------|---------------------------|----------|-------------|
| ID | Latin Name | Common Name | Growth Habit | Approximate Mature Height | Approximate Mature Spread | Scheduled Size | Planting Density (per/m2) | Quantity | |
| AlCa | Alpinia caerulea | Native Ginger | Shrub | 0.9 - 1.5m | 0.9 - 1.2m | 45L | 7 | 177 | |
| BlNu | Blechnum nudum | Fishbone Water Fern | Fern | 0.75 - 0.9m | 0.3 - 0.6m | 25L | 7 | 177 | |
| CiAn | Cissus antarctica | Kangaroo Vine, Water Vine | Climber | 3 - 5m | 2.0 - 3.5m | 140mm | 7 | 177 | |
| DiCa | Dianella caerulea | Paroo Lily, Blue Flax-lily | Grass | 0.45 - 0.6m | 0.3 - 0.6m | 200mm | 7 | 177 | |
| DoAs | Doodia aspera | Prickly Pasp Fern | Fern | 0.6 - 0.75m | 0.0 - 0.3m | 200mm | 7 | 177 | |
| HePe | Helichrysum petiolare | "Everlasting, Licorice Plant" | Shrub | 0.30 - 0.45m | 0.6 - 0.9m | 200mm | 7 | 177 | |
| LiPan | Libertia paniculata | Grass flag | Perennials | 0.40 - 0.60m | 0.30 - 0.60m | 200mm | 7 | 177 | |
| LoTa | Lomandra longifolia 'Tanika' | Spiny-head mat rush, spiky-headed mat-rush | Grass | 0.45 - 0.6m | 0.6 - 0.9m | 140mm | 7 | 177 | |
| FlAr | Flectranthus argenteatus | Flectranthus argenteatus | Shrub | 0.75 - 0.9m | 0.9 - 1.2m | 25L | 7 | 177 | |
| Total: | | | | | | | | | 1629 |

| MP02 - CIVIC LINK PLANTING MIX 02 | | | | | | | | | |
|-----------------------------------|-------------------------------|---|--------------|---------------------------|---------------------------|----------------|---------------------------|----------|-------------|
| ID | Latin Name | Common Name | Growth Habit | Approximate Mature Height | Approximate Mature Spread | Scheduled Size | Planting Density (per/m2) | Quantity | |
| BaVir | Baeckea virgata | "Nana" Baeckea | Shrub | 3 - 5m | 2.0 - 3.5m | 200mm | 7 | 106 | |
| BrMu | Brachyscome multifida | Cut Leaf Daisy | Ground Cover | 0.3 - 0.45m | 0.9 - 1.2m | 140mm | 7 | 106 | |
| DiCr | Dichelachne crinita | Longhair Plume Grass | Grass | 0.9 - 1.5m | 0.0 - 0.3m | 140mm | 7 | 106 | |
| DiRe | Dianella revoluta | "Spreading Flax Lily, Blueberry Lily, Blue Flax Lily" | Shrub | 0.75 - 0.9m | 0.3 - 0.6m | 140mm | 7 | 106 | |
| HaVAI | Hardenbergia violacea 'Meema' | White Hardenbergia | Climber | 1.5 - 3m | 2.0 - 3.5m | 200mm | 7 | 106 | |
| MyPa | Myoporum parvifolium | Carpet Spreading Myoporum | Shrub | 0.45 - 0.6m | 0.9 - 1.2m | 140mm | 7 | 106 | |
| OzDi | Ozothamnus diosmifolius | "Rice Flower, White Dogwood, Pill Flower, Sago Bush" | Shrub | 3 - 5m | 1.2 - 2.0m | 200mm | 7 | 106 | |
| PeAu | Pelargonium australe | Native Storksbill, Wild Geranium, Coastal Geranium | Ground Cover | 0.3 - 0.45m | 0.0 - 0.3m | 200mm | 7 | 106 | |
| PrRo | Prostanthera rotundifolia | Round-leaved Mint Bush | Shrub | 1.5 - 3m | 1.2 - 2.0m | 200mm | 7 | 106 | |
| WeFr | Westringia fruticosa | Coastal Rosemary | Shrub | 0.9 - 1.5m | 0.9 - 1.2m | 25L | 7 | 106 | |
| Total: | | | | | | | | | 1060 |

NOTE: Understorey species quantities indicative only. To be finalised for tender.

32 PHILLIP STREET

FUTURE PARRAMATTA POWERHOUSE

MP01 16.635 M2
LoTa - 7 P/SQM - 17
HePe - 7 P/SQM - 17
DiCa - 7 P/SQM - 17
HiSc - 7 P/SQM - 17
HaVi - 7 P/SQM - 17
GrFA - 7 P/SQM - 17
RhIn - 7 P/SQM - 17

MP01 6.43 M2
LoTa - 7 P/SQM - 6
HePe - 7 P/SQM - 6
DiCa - 7 P/SQM - 6
HiSc - 7 P/SQM - 6
HaVi - 7 P/SQM - 6
GrFA - 7 P/SQM - 6
RhIn - 7 P/SQM - 6

1-Ze-Zakova serrata 400L
16.158 M2 MP01
LoTa - 7 P/SQM - 16
HePe - 7 P/SQM - 16
DiCa - 7 P/SQM - 16
HiSc - 7 P/SQM - 16
HaVi - 7 P/SQM - 16
GrFA - 7 P/SQM - 16
RhIn - 7 P/SQM - 16

MP01 16.711 M2
LoTa - 7 P/SQM - 17
HePe - 7 P/SQM - 17
DiCa - 7 P/SQM - 17
HiSc - 7 P/SQM - 17
HaVi - 7 P/SQM - 17
GrFA - 7 P/SQM - 17
RhIn - 7 P/SQM - 17

Area stratavault
17m² x 0.600m = 10m³

Area stratavault
32m² x 0.600m = 20m³

PHILLIP STREET

69 PHILLIP STREET

CIVIC LINK MAIN WORKS

HORWOOD PLACE

75 PHILLIP STREET

NOTE: FINAL QUANTITIES AND SELECTION PENDING AVAILABILITY



© Copyright McGregor Coxall
AUS ACN 082 334 290
UK 10199853
PRC ID NO. 06000002201607080008
Sydney Melbourne Shenzhen Bristol
www.mcgregorcoxall.com

Client
CITY OF PARRAMATTA
Project Team
ARCADIS

Project Name
CIVIC LINK BLOCK 3 - EARLY WORKS PHILLIP STREET
Project No.
1066SYD
Address
Horwood Pl, Parramatta

Key Plan

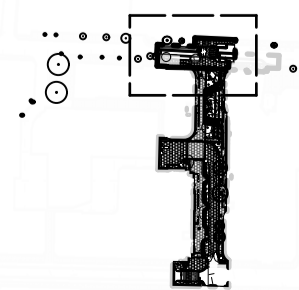

| Rev | Revision Description | By / Checked | Date |
|-----|-------------------------|--------------|------------|
| B | 100% DESIGN DEVELOPMENT | AD/XS/SB | 29/05/2024 |
| C | REVISED 100% DD | XS/SB | 31/01/2025 |
| D | REVISED 100% DD | XS/SB | 6/02/2025 |

Scale
1: 100 @ A1

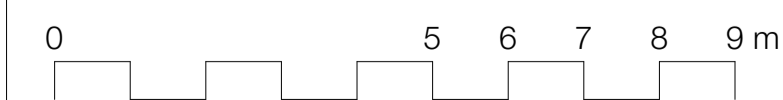

All dimensions are in millimetres unless otherwise noted.
Do not scale from this drawing.



Phase
Design Development
Sheet Title
PLANTING PLAN
Sheet No.
MCGC_L_501

Rev
D

REFER CIVIC LINK EARLY WORKS

69 PHILLIP STREET

75 PHILLIP STREET

1-CoCit-Corymbia citriodora 400L

1-EuSid-Eucalyptus sideroxylon 200L
 [MP-3] 28.14 M2
 FiNo - 7 P/SQM - 49
 GaCl - 7 P/SQM - 49
 ImCy - 7 P/SQM - 49
 LoTa - 7 P/SQM - 49

3-HymFI-Hymenosporum flavum 400L

57.203 M2 [MP02]
 LoTa - 7 P/SQM - 44
 DiCa - 7 P/SQM - 44
 PIaR - 7 P/SQM - 44
 DoAs - 7 P/SQM - 44
 AICa - 7 P/SQM - 44
 HePe - 7 P/SQM - 44
 BiNu - 7 P/SQM - 44
 LiPan - 7 P/SQM - 44
 CiAn - 7 P/SQM - 44

2-BraAc-Brachychiton acerifolius 400L

3-CoMac-Corymbia maculata 400L
 [MP02] 37.392 M2
 LoTa - 7 P/SQM - 29
 DiCa - 7 P/SQM - 29
 PIaR - 7 P/SQM - 29
 DoAs - 7 P/SQM - 29
 HePe - 7 P/SQM - 29
 AICa - 7 P/SQM - 29
 BiNu - 7 P/SQM - 29
 LiPan - 7 P/SQM - 29
 CiAn - 7 P/SQM - 29

1-EuSid-Eucalyptus sideroxylon 200L

FINAL EXTENT OF STRATA TBC

Area strata vault
 52m2 x 0.800m = 42m3

4-HymFI-Hymenosporum flavum 400L

72.446 M2 [MP02]
 LoTa - 7 P/SQM - 56
 DiCa - 7 P/SQM - 56
 PIaR - 7 P/SQM - 56
 DoAs - 7 P/SQM - 56
 HePe - 7 P/SQM - 56
 AICa - 7 P/SQM - 56
 BiNu - 7 P/SQM - 56
 LiPan - 7 P/SQM - 56
 CiAn - 7 P/SQM - 56

3-CoMac-Corymbia maculata 400L
 [MP01] 16.044 M2
 FiNo - 7 P/SQM - 28
 GaCl - 7 P/SQM - 28
 ImCy - 7 P/SQM - 28
 LoTa - 7 P/SQM - 28

1-BraAc-Brachychiton acerifolius 400L

[MP01] 7.621 M2
 FiNo - 7 P/SQM - 13
 GaCl - 7 P/SQM - 13
 ImCy - 7 P/SQM - 13
 LoTa - 7 P/SQM - 13

44.774 M2 [MP02]
 LoTa - 7 P/SQM - 35
 DiCa - 7 P/SQM - 35
 PIaR - 7 P/SQM - 35
 DoAs - 7 P/SQM - 35
 HePe - 7 P/SQM - 35
 AICa - 7 P/SQM - 35
 BiNu - 7 P/SQM - 35
 LiPan - 7 P/SQM - 35
 CiAn - 7 P/SQM - 35

[MP02] 16.61 M2
 LoTa - 7 P/SQM - 13
 DiCa - 7 P/SQM - 13
 PIaR - 7 P/SQM - 13
 DoAs - 7 P/SQM - 13
 HePe - 7 P/SQM - 13
 AICa - 7 P/SQM - 13
 BiNu - 7 P/SQM - 13
 LiPan - 7 P/SQM - 13
 CiAn - 7 P/SQM - 13

NOTE: Understorey species quantities indicative only. To be finalised for tender.

ADJOINS SHEET MCGC_L_502

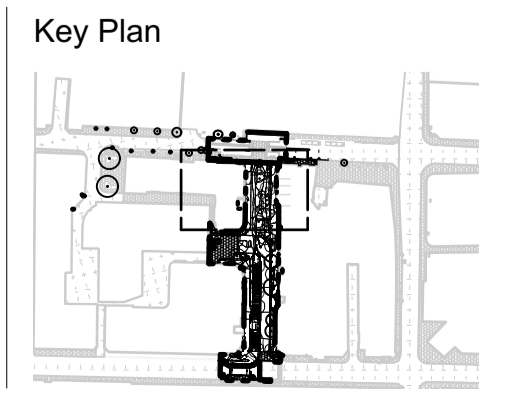

Issue Log

| | | | |
|---|-------------------------|-------|------------|
| B | 100% DESIGN DEVELOPMENT | AD/SB | 28/06/2024 |
| C | REVISED 100% DD | XS/SB | 31/01/2025 |
| D | REVISED 100% DD | XS/SB | 6/02/2025 |

Rev Revision Description By / Checked Date

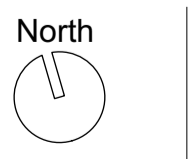
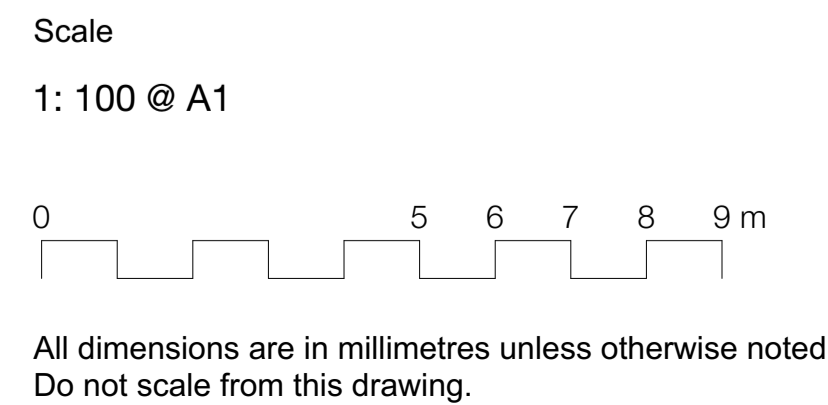

EAT STREET CAR PARK

AUCTIONEER LANE

2-CoMac-Corymbia maculata 400L

1-BraAc-Brachychiton acerifolius 400L

Area stratavault
47m² x 0.800m = 38m³

EXTENT OF STRATAVAULT TO BE CONFIRMED

1-CoCit-Corymbia citriodora 400L

1 HORWOOD PLACE

1-BraAc-Brachychiton acerifolius 400L

[MPO3] 36,577 M2
PrRo - 7 P/SQM - 26
WeFr - 7 P/SQM - 26
OzDi - 7 P/SQM - 26
BaVir - 7 P/SQM - 26
HaVIAI - 7 P/SQM - 26
DiRe - 7 P/SQM - 26
DiCr - 7 P/SQM - 26
BrMu - 7 P/SQM - 26
PeAu - 7 P/SQM - 26
MyPa - 7 P/SQM - 26

Area stratavault
38m² x 0.800m = 30.4m³

1-CoCit-Corymbia citriodora 400L

EXTENT OF STRATAVAULT TO BE CONFIRMED

3-CoMac-Corymbia maculata 400L

17,754 M2 [MPO3]
PrRo - 7 P/SQM - 12
WeFr - 7 P/SQM - 12
OzDi - 7 P/SQM - 12
BaVir - 7 P/SQM - 12
HaVIAI - 7 P/SQM - 12
DiRe - 7 P/SQM - 12
DiCr - 7 P/SQM - 12
BrMu - 7 P/SQM - 12
PeAu - 7 P/SQM - 12
MyPa - 7 P/SQM - 12

2-HymFI-Hymenosporum flavum 400L

2 HORWOOD PLACE

2-CoMac-Corymbia maculata 400L

30,219 M2 [MPO3]
PrRo - 7 P/SQM - 21
WeFr - 7 P/SQM - 21
OzDi - 7 P/SQM - 21
BaVir - 7 P/SQM - 21
HaVIAI - 7 P/SQM - 21
DiRe - 7 P/SQM - 21
DiCr - 7 P/SQM - 21
BrMu - 7 P/SQM - 21
PeAu - 7 P/SQM - 21
MyPa - 7 P/SQM - 21

EXTENT OF STRATAVAULT TO BE CONFIRMED

Area stratavault
125m² x 0.800m = 100m³

HORWOOD PLACE

Area stratavault
25m² x 0.800m = 20m³

1-CoMac-Corymbia maculata 400L

EXTENT OF STRATAVAULT TO BE CONFIRMED

3 HORWOOD PLACE

NOTE: Understorey species quantities indicative only. To be finalised for tender.



© Copyright McGregor Coxall
AUS ACN 082 334 290
UK 10199853
PRC ID NO. 06000002201607080008
Sydney Melbourne Shenzhen Bristol
www.mcgregorcoxall.com

Client
CITY OF PARRAMATTA
Project Team
ARCADIS

Project Name
CIVIC LINK BLOCK 3 - MAIN WORKS HORWOOD PL
Project No.
1066SYD
Address
Horwood Pl, Parramatta

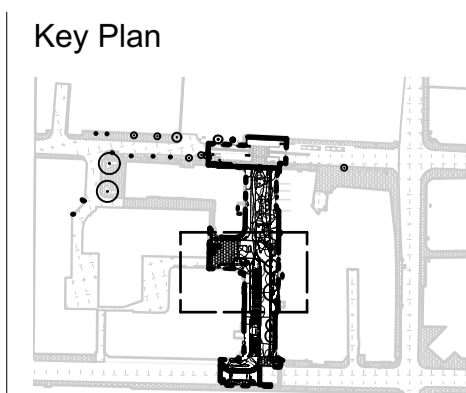

| Rev | Revision Description | By / Checked | Date |
|-----|-------------------------|--------------|------------|
| A | 50% DESIGN DEVELOPMENT | AD/XS/SB | 7/06/2024 |
| B | 100% DESIGN DEVELOPMENT | AD/SB | 28/06/2024 |
| C | REVISED 100% DD | XS/SB | 31/01/2025 |

Scale
1: 100 @ A1

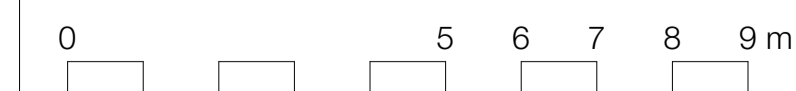

All dimensions are in millimetres unless otherwise noted.
Do not scale from this drawing.

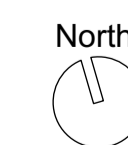

Phase
Design Development
Sheet Title
PLANTING PLAN
Sheet No.
MCGC_L_502

Rev
C

1-EuSid-Eucalyptus sideroxylon 200L

2 HORWOOD PLACE

3-HymFI-Hymenosporum flavum 400L

- 25.269 M2 [MP03]
- PrRo - 7 P/SQM - 18
- WeFr - 7 P/SQM - 18
- OzDi - 7 P/SQM - 18
- BaVir - 7 P/SQM - 18
- HaVAI - 7 P/SQM - 18
- DiRe - 7 P/SQM - 18
- DiCr - 7 P/SQM - 18
- BrMu - 7 P/SQM - 18
- PeAu - 7 P/SQM - 18
- MyPa - 7 P/SQM - 18

Area stratavault
125m² x 0.800m = 100m³

EXTENT OF STRATAVAULT TO BE CONFIRMED

HORWOOD PLACE

5 HORWOOD PLACE

1-HymFI-Hymenosporum flavum 400L

2-CoMac-Corymbia maculata 400L

- 31.03 M2 [MP03]
- PrRo - 7 P/SQM - 22
- WeFr - 7 P/SQM - 22
- OzDi - 7 P/SQM - 22
- BaVir - 7 P/SQM - 22
- HaVAI - 7 P/SQM - 22
- DiRe - 7 P/SQM - 22
- DiCr - 7 P/SQM - 22
- BrMu - 7 P/SQM - 22
- PeAu - 7 P/SQM - 22
- MyPa - 7 P/SQM - 22

Area stratavault
43m² x 0.800m = 34m³

Area stratavault
25m² x 0.800m = 20m³

36 PHILLIP STREET

EXTENT OF STRATAVAULT TO BE CONFIRMED

EXTENT OF STRATAVAULT TO BE CONFIRMED

1-CoMac-Corymbia maculata 400L

54 GEORGE STREET

GEORGE STREET

GEORGE STREET DEFERRED SCOPE:
THESE WORKS TO BE CONSTRUCTED LATER AS PART OF SYDNEY METROWEST
CAPITAL WORKS - EXPECTED COMPLETION BY 2032

NOTE: Understorey species quantities indicative only. To be finalised for tender.



Client
CITY OF PARRAMATTA
Project Team
ARCADIS

© Copyright McGregor Coxall
AUS ACN 082 334 290
UK 10199853
PRC ID NO. 06000002201607080008
Sydney Melbourne Shenzhen Bristol
www.mcgregorcoxall.com

Project Name
CIVIC LINK BLOCK 3 - MAIN WORKS HORWOOD PL
Project No.
1066SYD
Address
Horwood Pl, Parramatta

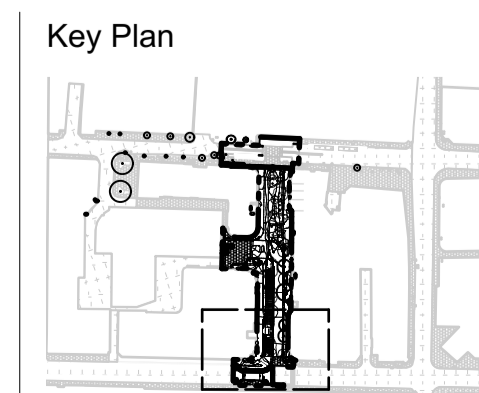

| Rev | Revision Description | By / Checked | Date |
|-----|-------------------------|--------------|------------|
| A | 50% DESIGN DEVELOPMENT | AD/XS/SB | 7/06/2024 |
| B | 100% DESIGN DEVELOPMENT | AD/SB | 28/06/2024 |
| C | REVISED 100% DD | XS/SB | 31/01/2025 |

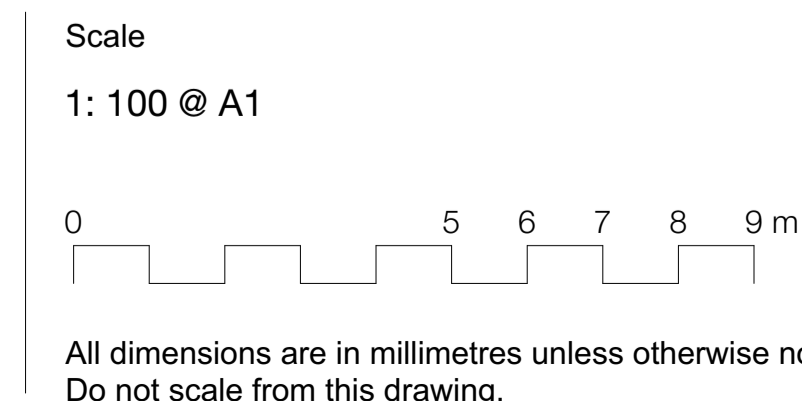

Phase
Design Development
Sheet Title
PLANTING PLAN
Sheet No.
MCGC_L_503

Rev
C