

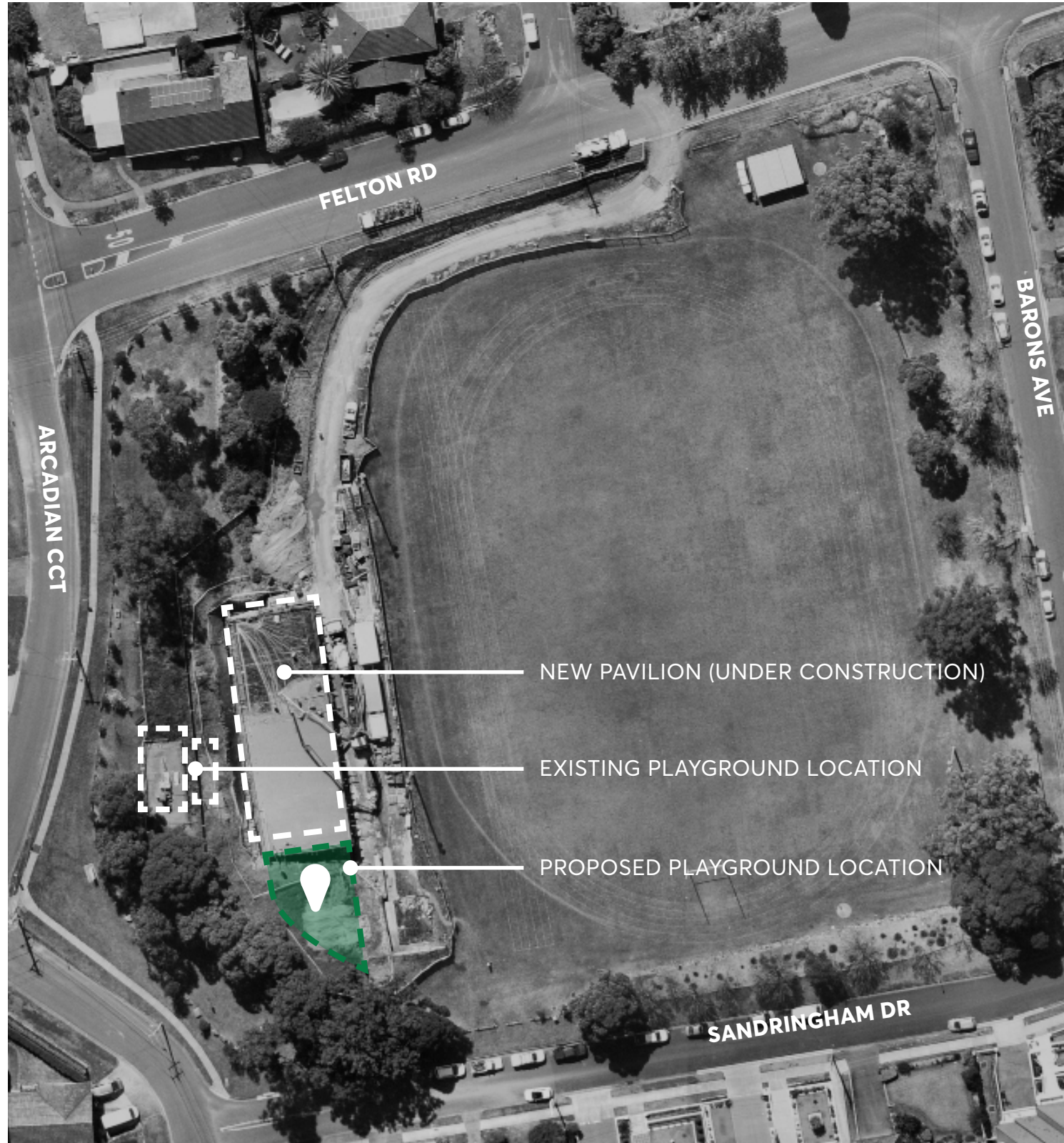



**SITE CONTEXT**



**SITE PHOTOS**



**EXISTING LOCATION**



**PROPOSED LOCATION**

THE NEW PLAYGROUND LOCATION HAS BEEN SELECTED TO ALLOW FOR BETTER CONNECTIVITY AND SURVEILLANCE FROM THE SPORTSGROUND AND PLAYGROUND. THE SLOPING SITE ALSO CREATES THE OPPORTUNITY TO DESIGN A PLAYGROUND THAT MEETS THE COMMUNITY DESIRE FOR A MORE ADVENTUROUS PLAY WITH SLIDING AND CLIMBING ELEMENTS.



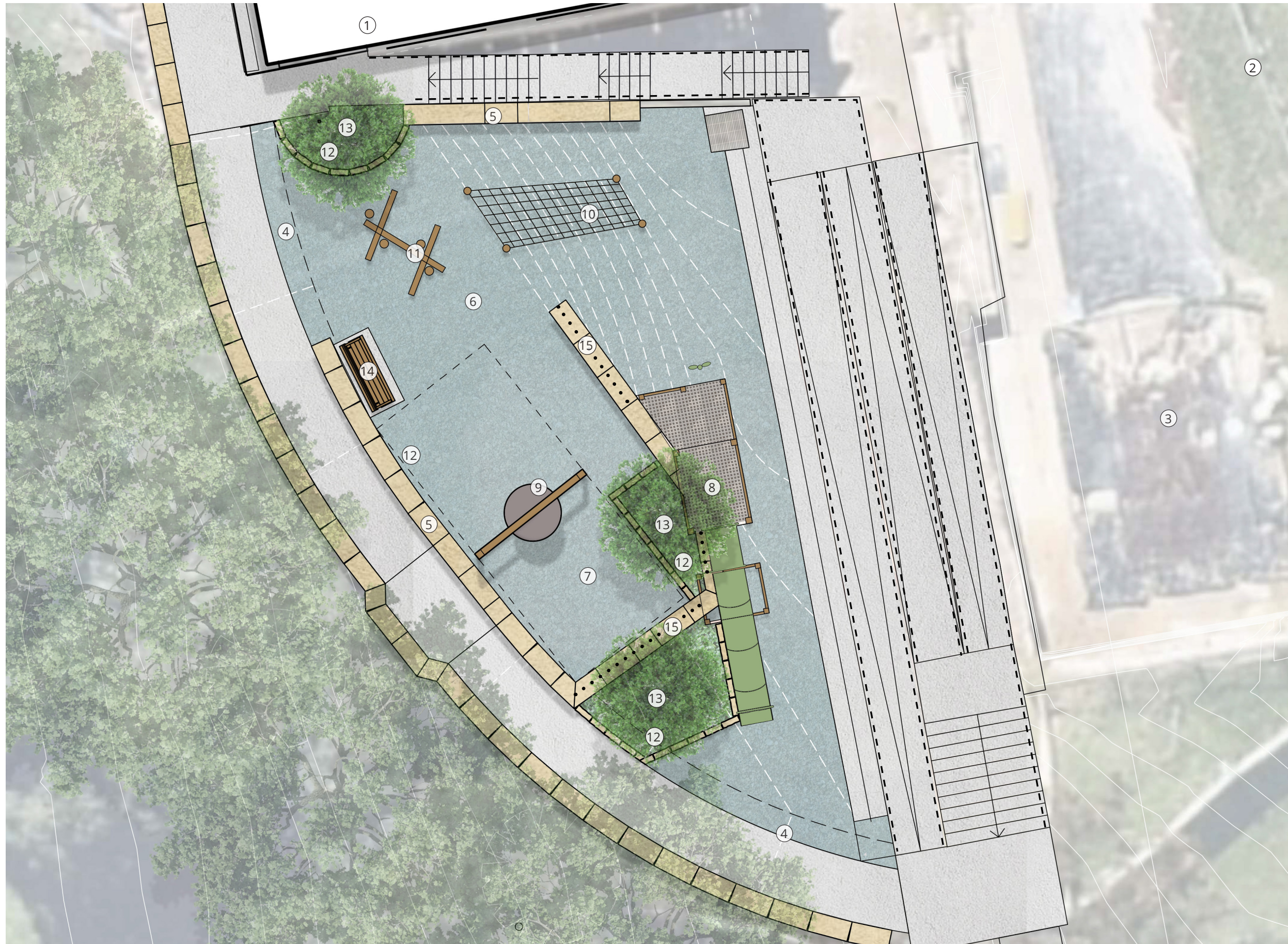

## LEGEND

- ① New Sports Pavilion (Currently under Construction)
- ② Existing Kingsdene Oval
- ③ Existing Long Jump Pit
- ④ Entry points into new playground
- ⑤ Proposed sandstone retaining wall to create upper and lower playground levels
- ⑥ Proposed rubber softfall surfacing
- ⑦ Proposed playground mulch surfacing
- ⑧ Proposed timber play tower with tube slide, climbing pole and look out points
- ⑨ Proposed swing with basket seat.
- ⑩ Proposed embankment with climbing net
- ⑪ Proposed timber nature play elements such as balance beams and steppers
- ⑫ Proposed planting beds with low water native species
- ⑬ Proposed medium sized native trees for shade
- ⑭ Proposed bench seating
- ⑮ Proposed custom timber fencing



**FIRST ONLINE 'PLAY YOUR WAY!' - COMMUNITY CONSULTATION DATA**  
(NOVEMBER 2022)

**Q:** Do you support having more exciting and challenging play opportunities provided for children at the playground in Peggy Womersley Reserve?



41 Responses were received, with the respondents voting:

- Yes - 41 (95.4%)
- Yes, to an extent - 1 (2.3%)
- No - 1 (2.3%)

**Q:** What type of play options would you like to see delivered at Peggy Womersley Reserve?



All 24 participants responded, and state they wanted to see the following:

- Sliding & Climbing - 39 Respondents
- Natural & Adventurous - 26 Respondents
- Active & Dynamic - 24 Respondents
- Spinning, Rocking & Swinging - 21 Respondents
- Crawling & Balancing - 19 Respondents

- **Sliding & Climbing -**
  - ① - Tube slide
  - ② - Embankment with climbing net
  - ③ - Climbing pole
- **Natural & Adventurous -**
  - ④ - Nature play (log steppers & balance beams)
  - ⑤ - Timber play structure
  - ② - Embankment with climbing net
  - ③ - Climbing pole
- **Active & Dynamic -**
  - ④ - Nature play (log steppers & balance beams)
  - ② - Embankment with climbing net
  - ③ - Climbing pole
- **Spinning, Rocking & Swinging -**
  - ⑥ - Swing with basket seat
- **Crawling & Balancing -**
  - ④ - Nature play (log steppers & balance beams)

**PLAY EQUIPMENT SAMPLE IMAGES**



Artistic impression of new playground

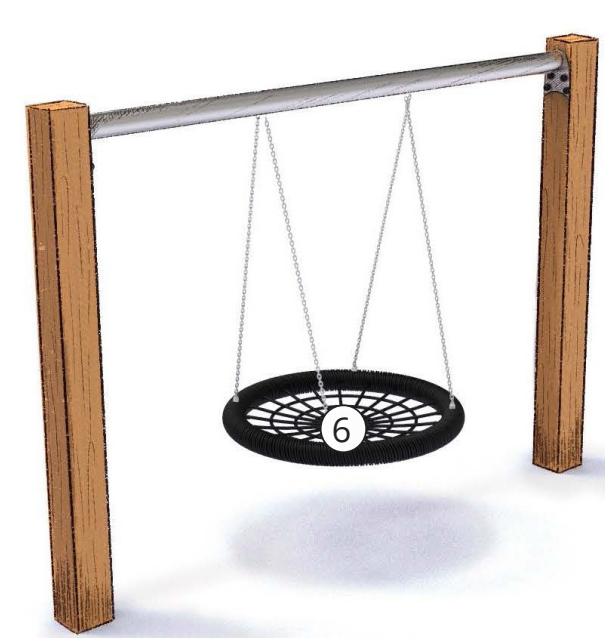

Timber swing set with basket seat

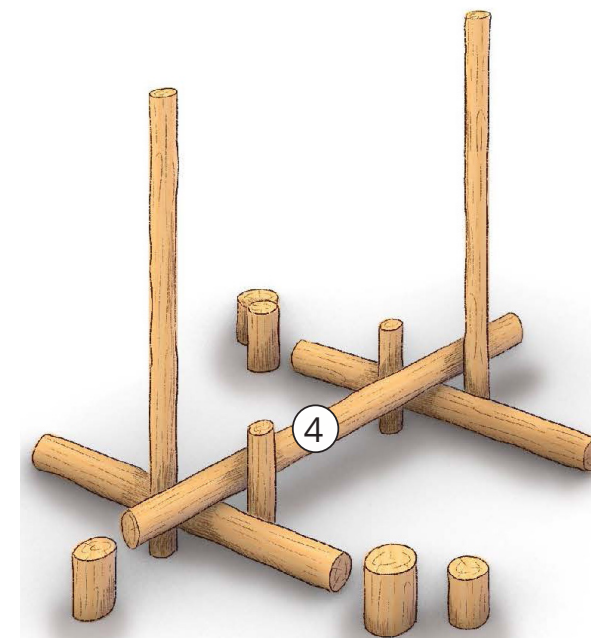

Nature play log steppers & balance beams

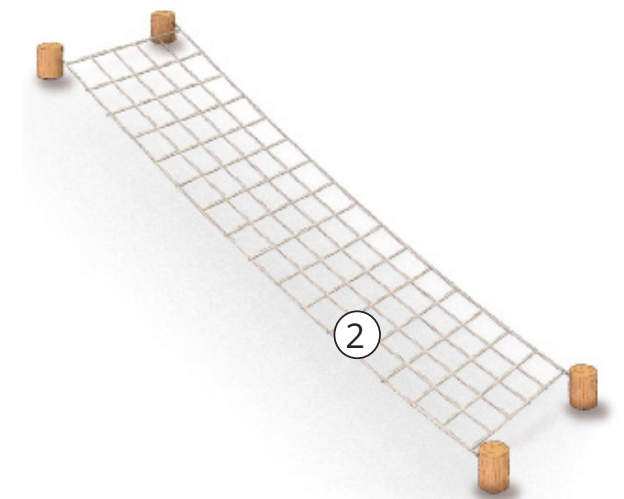

Embankment climbing net