



# TELOPEA SKATEPARK UPGRADE

DRAFT CONCEPT REPORT

CITY OF PARRAMATTA

26 JUNE 2020

CONVIC



ACKNOWLEDGEMENTS

Convic Pty Ltd. acknowledge the contributions of all those who participated in the prior phases of the Telopea Skatepark Upgrade, including the City of Parramatta Council staff, residents, community groups and other stakeholders who responded to the various opportunities for input and/or who provided advice and information where required.

QUALITY INFORMATION

PROJECT NAME

TELOPEA SKATEPARK UPGRADE

PROJECT NO.

20015

PREPARED BY

Alex Boyd

REVIEWED BY

Simon Bogalo

PREPARED BY



FOR



REVISION HISTORY

REVISION	REVISION DATE	DETAILS	AUTHORISED	
			NAME / POSITION	SIGNATURE
A	26.06.20	DRAFT REPORT	BRYCE HINTON/ DESIGN MANAGER	

# CONTENTS

<b>INTRODUCTION</b>	<b>01</b>
Introduction	04
<b>SITE CONTEXT</b>	<b>02</b>
Understanding Site Context	05
<b>UNDERSTANDING SKATE CONTEXT</b>	<b>03</b>
Existing Skate Network	06
Existing Skate Provision	07
<b>DESIGN VISION</b>	<b>04</b>
Community Reflective	08
<b>DESIGN IDEATION</b>	<b>05</b>
Concept Ideation	09
<b>CONCEPT</b>	<b>06</b>
Layout Plan	10
Perspective - 01	11
Perspective - 02	12
Perspective - 03	13
Perspective - 04	14
<b>CONCLUSION</b>	<b>05</b>
Moving Forward	15



## BACKGROUND

The Telopea Skatepark Upgrade is to be developed as a unique, iconic and site responsive facility that aims to complement the existing uses and facilities of Sturt Park and the proposed master plan. This facility will be al hub for the youth and the broader community of Telopea and the wider City of Parramatta Region.

The following report makes recommendations on the typology of the facility and creates a community driven design vision for the Telopea Skatepark Upgrade. This strategic approach will define and inform the conceptual response for the current community demand, skate trends and future community needs.





### UNDERSTANDING SITE CONTEXT

The City of Parramatta are proposing an upgrade to the existing Telopea Skate Park as part of the development of the Sturt Park improvements, a key item of the Telopea Precinct Masterplan. This precinct is set to revitalise the Telopea area to create a vibrant, diverse and cohesive community hub while enhancing the livability of the neighbourhood.

The site is located on Sturt Street, a key link into the heart of Telopea, with Telopea Public School and the Benaud Place shopping precinct sitting adjacent. The site is bordered to the south by The Ponds Creek, an important and significant environmental and ecological waterway, as well as a site of indigenous importance.

With the existing site features and proposed masterplan development, the facility will create a dynamic and activated central community hub to offer recreational and social experiences for all members of the community; from day to day usage to larger community events. As one of a network of youth spaces within the area it will be a strategic public realm hub for Telopea and the wider Western Sydney area, becoming a destination for youth within the region.

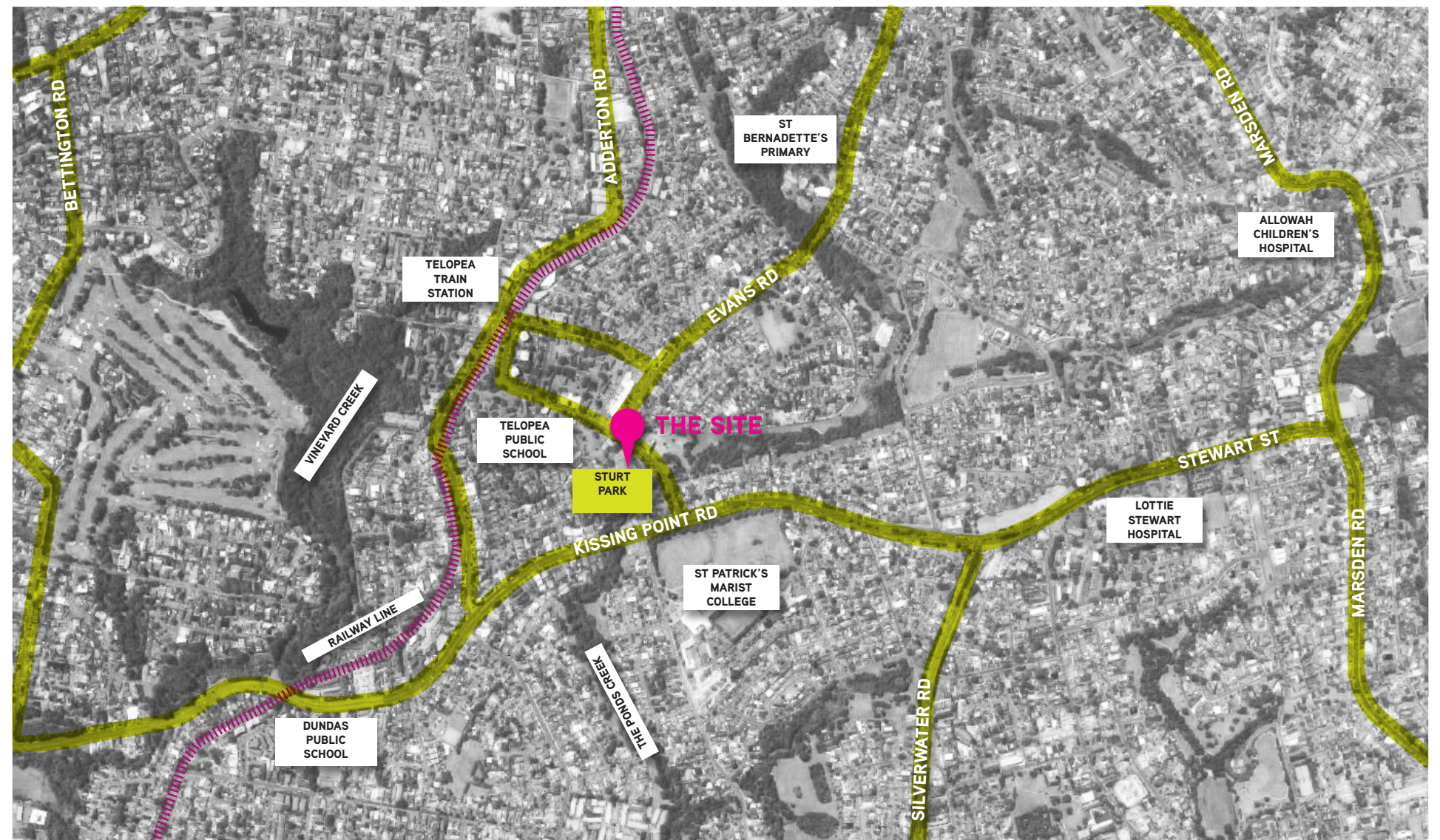

## EXISTING SKATE NETWORK

The skate and action wheel sport scene is highly established within the City of Parramatta municipality, Sydney, and the greater New South Wales region.

While many skate parks have a number of similar features due to their diversity in use, it is important to undertake a study of parks within a 15km radius of the proposed development. This further develops the typology of the proposed facility, while identifying possible gaps in skate features or styles of other regional, local or district skate parks.

As a result of this desktop study a design can be developed for the Telopea Skatepark Upgrade that further enriches the existing skate space infrastructure within the greater Sydney context.

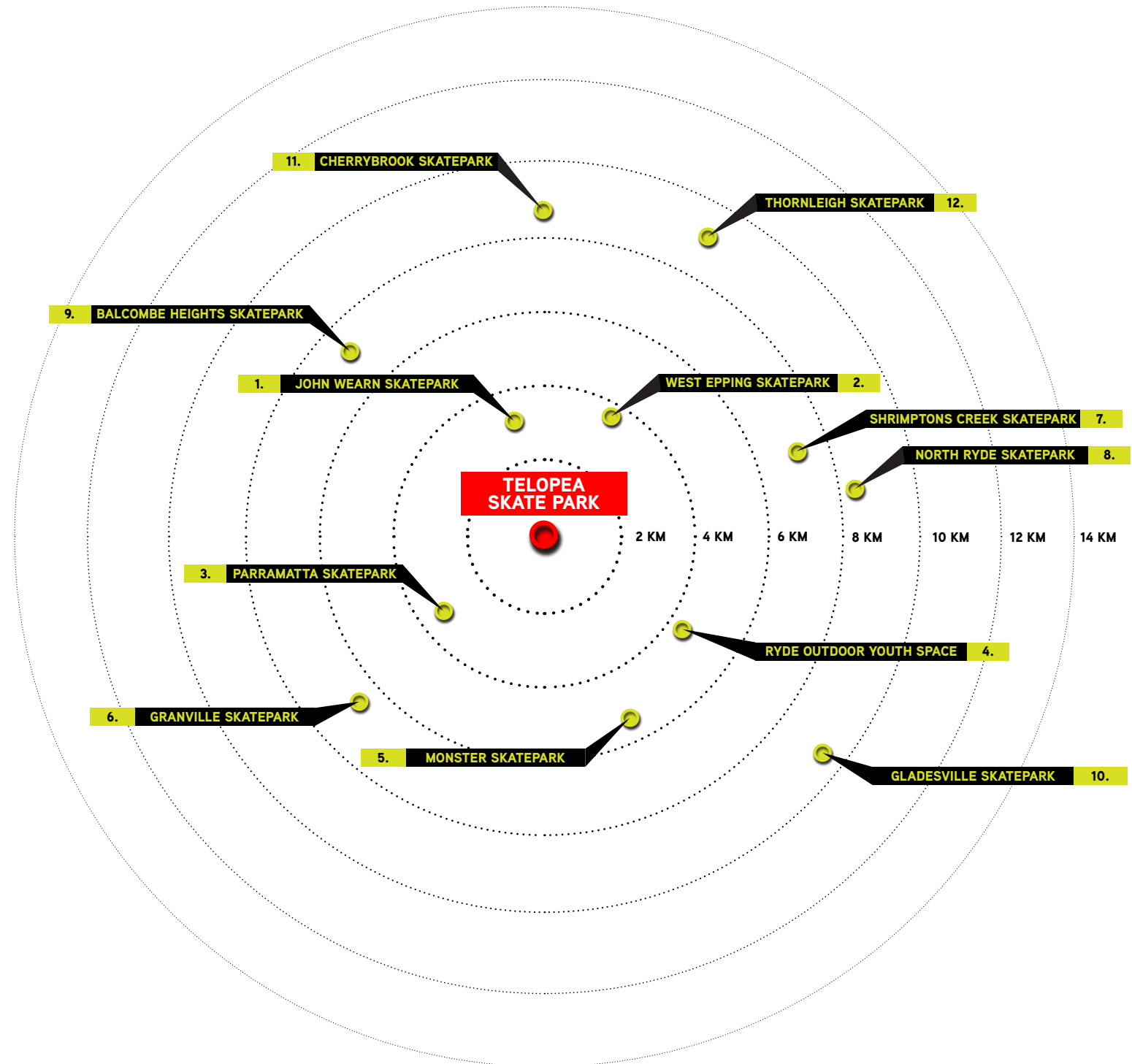



# UNDERSTANDING SKATE CONTEXT

## EXISTING SKATE PROVISION

In addition to the future upgrade of the Telopea Skatepark, there are numerous skate facilities located within the LGA and surrounding regions that are to be evaluated and analysed. These parks include:

1. John Wearn Reserve Skatepark - (2.8km)
2. West Epping Skatepark - (3.6km)
3. Parramatta Skatepark - (3.8km)
4. Ryde Outdoor Youth Space - (4.1km)
5. Monster Skatepark - (5.6km)
6. Granville Skatepark - (6.3km)
7. Shrimptons Creek Skatepark - (6.9km)
8. North Ryde Skatepark - (8.2km)
9. Balcombe Heights Skatepark - (6.9km)
10. Gladesville Skatepark - (9.7km)
11. Cherrybrook Skatepark - (8.6km)
12. Thornleigh Skatepark - (9.1km)

The study of the above parks has identified that the City of Parramatta region provides a wide variety of skate parks and facilities that offer both street and transitional style elements and features. The Telopea Skatepark Upgrade should add a variation to these parks through unique design elements and features which are specific to Telopea and put the park 'on the map' as a destination facility creating a different experience from existing parks in the region.

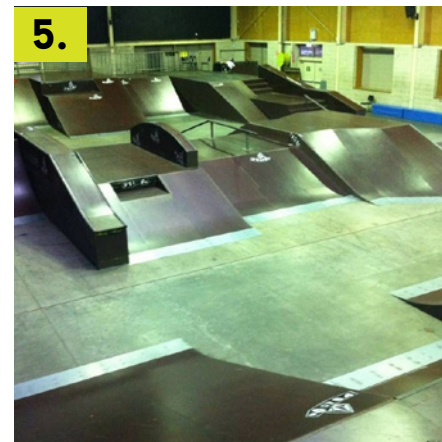



## BRINGING A CONTEMPORARY, ACTIVATED, COMMUNITY REFLECTIVE SKATE SPACE TO THE TELOPEA COMMUNITY AND WIDER PARRAMATTA REGION.

As part of the Telopea Skatepark Upgrade, a community driven design vision has been developed to guide the proposed facility design, this is as follows:

### DESIGN DIRECTION

All consultation results and discussions, including; skate, amenity and landscape suggestions and ideas have been collated by City of Parramatta. This feedback informs of the needs and wants of the community and are to be taken into consideration when designing the Telopea Skatepark Upgrade.

#### SITE RESPONSIVE

Within the Sturt Park Upgrade Master Plan, the Telopea Skatepark site has an adjoining relationship with the park frontage and entry, and the proposed amphitheatre. Key items to be addressed within the concept design are to effectively connect with these surrounding facilities through the design of pedestrian circulation and access pathways.

#### SKATE TYPOLOGY

Based on the community consultation undertaken by City of Parramatta, desktop analysis of existing skate facilities within the LGA, and the presence of many newly constructed transition heavy skateparks in the surrounding area, a “DIY” street style facility has been identified as the most suitable.

DIY skate spots are an intrinsic part of skate culture, where locals, create their own skate spaces through self funded materials and labour. The result is a grungy amalgamation of mismatched features and obstacles that nods to the culture of street skating and do it yourself attitude.

The concept design will be in stark juxtaposition to the surrounding skateparks, but will fill a hole in the Sydney skatepark provisions, and will serve as a desirable destination to those users wishing for a different skatepark experience.

#### SKATE OBSTACLE PROVISION

A focus on unique style street features with back and forth flow, creative lines and design influences from DIY style skate spots. The design has been kept flat and open, key for the functionality of DIY locations.

#### SKILL LEVEL PROVISION

The upgraded design will cater towards beginner to advanced skill levels. The proposed concept design will reflect these user skill levels with the inclusion of a diverse range of features that can be used by beginners, intermediate and advanced riders that continually challenge and develop user skill levels.

#### USER + SPECTATOR AMENITIES

To ensure a central community space with comfort for users and spectators, the concept design will offer a number of social opportunities with areas of refuge located at key skate rest points along main pedestrian circulation areas.

The footprint of the proposed skatepark upgrade is nestled amongst existing trees, and adjacent to picnic and pedestrian areas proposed in the master plan.

#### INTEGRATION

The concept design is to be integrated seamlessly into the design of the proposed Sturt Park Upgrade and its surroundings. The Telopea Skatepark will be a key youth community hub, situated in a central location to many schools and other community facilities.



# 05

## DESIGN IDEATION

### CONCEPT IDEATION

The concept is inspired by the creativity of those making DIY skating spots in public spaces.

Currently Sydney has had major expansion in skateparks throughout the region with many varieties of skate style. To expand on the already developing scene this facility takes inspiration from DIY skate spots which takes a step away from the traditional skatepark and is instead made up of many smaller unique obstacles all with a variety of use dependant on the user.

The functionality of these obstacles is dependant on space around the feature to use from a variety of angles. Each obstacle becomes its own challenge and when all combine it forms a unique destination within local and wider regional context.





## LEGEND

### SKATE WORKS

- 1 Jersey Barrier
- 2 Concrete Wallie Ball
- 3 School Picnic Table
- 4 Slappy Kerb
- 5 Taco 750H
- 6 Street Spine 600H with Moguls
- 7 Entry Stairs
- 8 Hubba
- 9 Flat Ledge 400H
- 10 Quarter Pipe 800H
- 11 Kicker to Step Gap
- 12 Flat Bar 400H
- 13 200H Manual Pad
- 14 China Bank 600H
- 15 Noping Quarter Pipe 800H
- 16 Blockwork Tombstone Extension
- 17 Existing Platform Extension
- 18 Pole Jam

### LANDSCAPE WORKS

- 1 Block Seating
- 2 Existing Tree
- 3 Shade Tree
- 4 Connecting Pathways
- 5 Turfed Refuge Areas
- 6 Rubbish Bins

### REFURBISHMENT WORKS

- 1 Existing Bowl to be Cleaned & Resealed



CLIENT



0 1 2 5 10  
scale 1:200 @ A3



# CONVIC

Unit 13, 46-50 Regent Street  
Richmond VIC 3121  
T (03) 9486 9899  
Convic.com

**PROJECT**  
Telopea SP Upgrade

**TITLE**  
Layout Plan

**DATE**  
26.06.2020

**REVISION**  
A





## PERSPECTIVE - 01



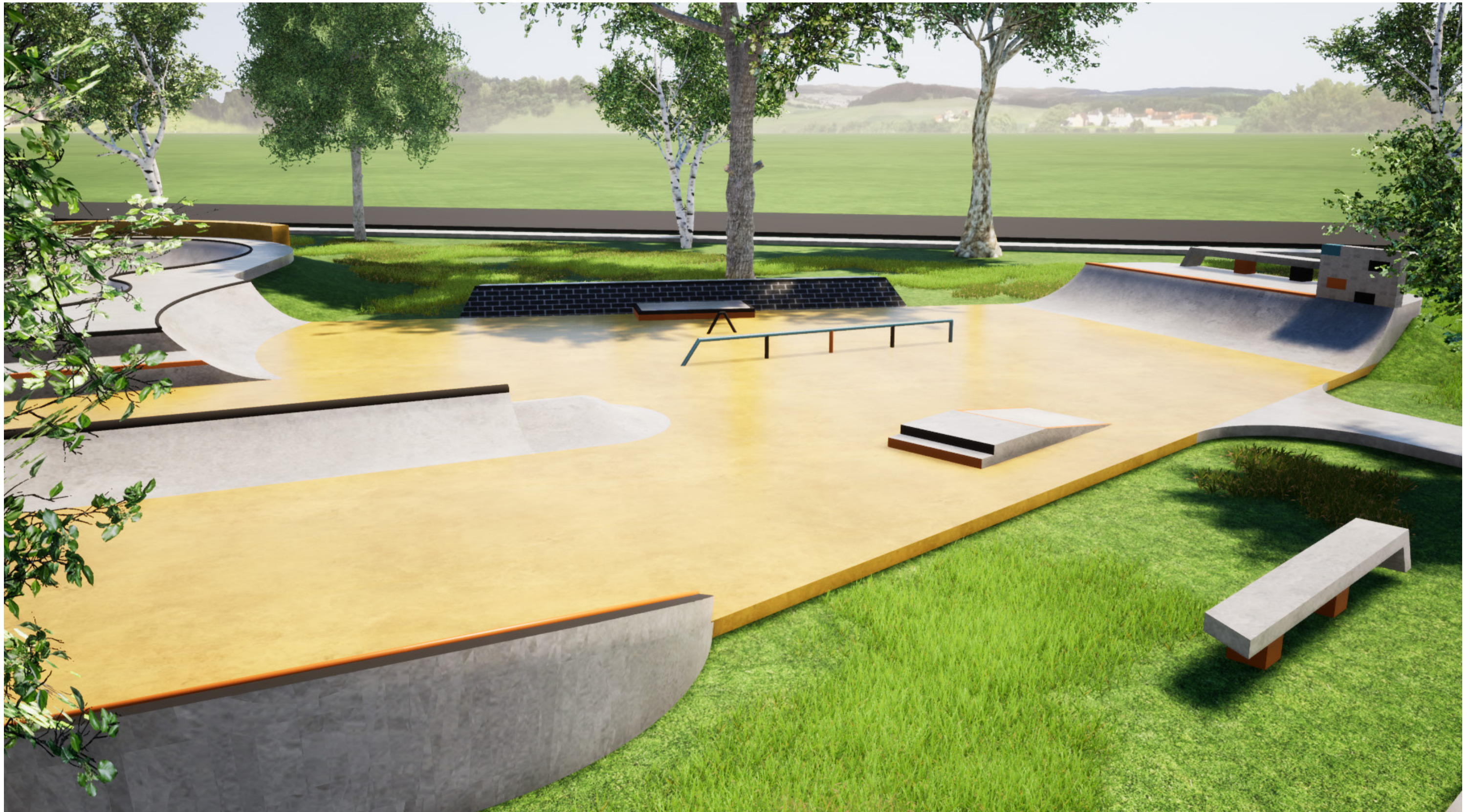

PERSPECTIVE - 02





PERSPECTIVE - 03



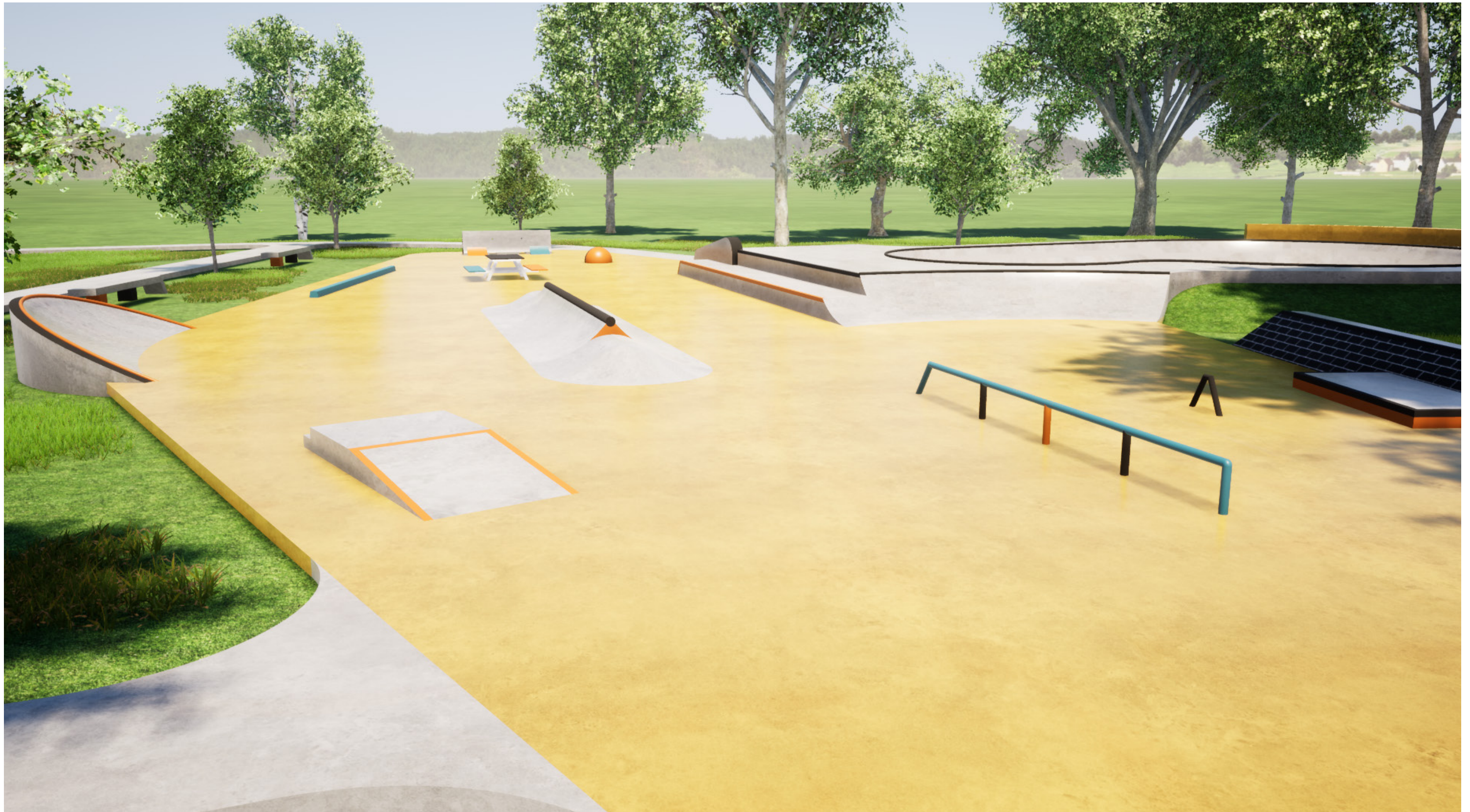

PERSPECTIVE - 04



## MOVING FORWARD

Upon Council endorsement of the draft concept design a community presentation video and survey will be produced and presented online where community members can provide comments on the design and workshop ideas to include in the final concept design. As well as creating a truly relevant design, this input will ensure the final concept design reflects community needs, user requirements and the overall project vision.

# CONVIC

**CREATE COMMUNITY**

UNIT 13, 46-50 REGENT STREET  
RICHMOND VIC 3121 AUSTRALIA  
T +61 3 9486 9899 F +61 3 9486 9088  
CONVIC.COM