

EXISTING SIGNAGE SCHEDULE

SIGN	SIGN NO.	QUANTITY REQUIRED	REMARKS
	R2-4 (R/L&R/L)	L: 9 R: 7 L&R: 7	AS INDICATED ON PLAN
	R5-1-3 (R/L)	R: 1 L: 1	
	R5-400 (R/L&R/L)	R: 12 L&R: 2 L: 8	
	R1-1	3	
	G5-1	12	
	R5-40 (R/L)	R: 2 L: 2	
	R5-41 (R/L)	R: 1 L: 1	
	R4-10	1	
	R1-3	5	
	R3-1	8	
	W6-3	1	
	W8-3	3	
	T5-5	3	
	R2-3 (L)	2	

EXISTING SIGNAGE SCHEDULE

SIGN	SIGN NO.	QUANTITY REQUIRED	REMARKS
	W6-3	1	AS INDICATED ON PLAN
	W2-7	1	
	R2-209	1	
	W8-2	1	
	W3-4	1	

PROPOSED SIGNAGE SCHEDULE

SIGN	SIGN NO.	QUANTITY REQUIRED	REMARKS
	R7-4	4	AS INDICATED ON PLAN
	R8-2	9	

SHARED PATH PAVEMENT MARKING

SIGN	SIGN NO.	QUANTITY
	T1S02	5
	T1S01	5
	T1L01	160m

NOTE: REFER 'CITY OF SYDNEY SHARED PATHWAYS-PAVEMENT MARKINGS GUIDE' FOR DETAILS ON THE PAVEMENT MARKINGS SPECIFIED ABOVE.

File location: z:\projects\3024\_pmc\_epping\_to\_carlingford\_active\_transport\link\03\_design\vacat\working\2\_bridg\_street\3024-02-sl (2) - copy.dwg

No.	Revision	Checked	Approved	Date	STATUS
--	TRAFFIC COMMITTEE	BS	NP	12/02/20	TRAFFIC COMMITTEE
	Revision - Revise on CAD do not amend by hand				

Copyright  
This document is & shall remain the property of Complete Urban Pty Ltd.  
The document may only be used for the purpose for which it was commissioned & in accordance with the terms of engagement for the commission. Unauthorised use of this document in any way is prohibited.



10 Regent Street  
Chippendale NSW 2008

p 02 9282 9900  
f 02 9282 9277

**COMPLETE**

ABN 64 100 037 812  
www.completeurban.com.au

SCALE:			
Drawn	BS	Designed	BS
Drafting	NP	Design	NP
Check	NP	Check	NP
Approved			
<b>NOT FOR CONSTRUCTION</b>			
This Drawing must not be used for Construction unless signed as Approved			

Client and Job	CITY OF PARRAMATTA COUNCIL EPPING TO CARLINGFORD ACTIVE TRANSPORT LINK PROJECT 2- BRIDGE STREET, EPPING
Title	TRAFFIC COMMITTEE PLANS SHEET 00 OF 08
Drg. No.	3024-02-TC-00
Size	A1
Rev	--

DO NOT SCALE

GENERAL LEGEND	
CONCRETE FOOTPATH/ SHARED PATH	
CONCRETE KERB RAMP	
PLANTING AS SPECIFIED	
EXISTING TREE REMOVAL	
RETAIN EXISTING TREE	
CONCRETE K&G	
PROPOSED LINEMARKING	
CONCRETE DRIVEWAY	
REINSTATE ASPHALT PAVEMENT	
CONSTRUCT KERB INLET PIT/ JUNCTION PIT	
INSTALL STORMWATER PIPE (DIMENSIONS AS INDICATED ON PLANS)	
REMOVE POWER POLE/ LIGHT POLE	

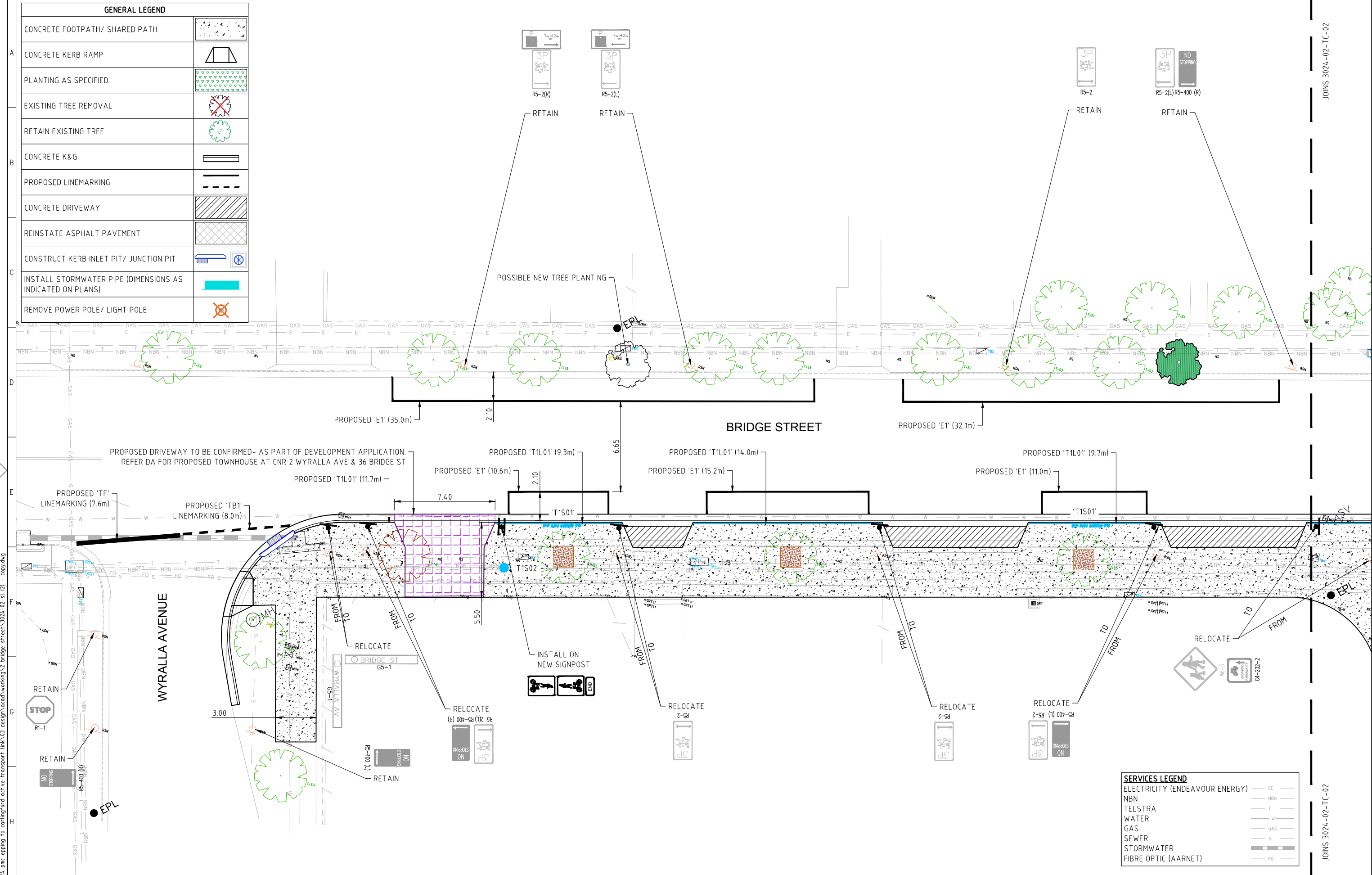

JOINS 3024-02-TC-02

JOINS 3024-02-TC-02

File location: z:\projects\3024\_pmc\_epping\_to\_carlingford\_active\_transport\_link\03\_design\acad\working\2\_bridge\_street\3024-02-sl (2) - copy.dwg

No.	Revision	Checked	Approved	Date	STATUS
1	Revision - Revise on CAD do not amend by hand			12/02/20	TRAFFIC COMMITTEE

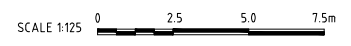

Copyright  
 This document is & shall remain the property of Complete Urban Pty Ltd.  
 This document may only be used for the purpose for which it was commissioned & in accordance with the terms of engagement for the commission. Unauthorised use of this document in any way is prohibited.



10 Regent Street  
 Chippendale NSW 2008  
 p 02 9282 9900  
 f 02 9282 9277

**COMPLETE**

ABN 64 100 037 812  
 www.completeurban.com.au

Drawn	BS	Designed	BS
Drafting	NP	Design	NP
Check	NP	Check	NP
Approved			
<b>NOT FOR CONSTRUCTION</b>			
This Drawing must not be used for Construction unless signed as Approved			

Client and Job	CITY OF PARRAMATTA COUNCIL EPPING TO CARLINGFORD ACTIVE TRANSPORT LINK PROJECT 2- BRIDGE STREET, EPPING
Title	TRAFFIC COMMITTEE PLANS SHEET 01 OF 08
Drg. No.	3024-02-TC-01
Scale	A1
Rev	--

SERVICES LEGEND	
ELECTRICITY (ENDEAVOUR ENERGY)	EE
NBN	NBN
TELSTRA	T
WATER	W
GAS	GAS
SEWER	S
STORMWATER	SW
FIBRE OPTIC (AARNET)	FO

GENERAL LEGEND	
CONCRETE FOOTPATH/ SHARED PATH	
CONCRETE KERB RAMP	
PLANTING AS SPECIFIED	
EXISTING TREE REMOVAL	
RETAIN EXISTING TREE	
CONCRETE K&G	
PROPOSED LINEMARKING	
CONCRETE DRIVEWAY	
REINSTATE ASPHALT PAVEMENT	
CONSTRUCT KERB INLET PIT/ JUNCTION PIT	
INSTALL STORMWATER PIPE (DIMENSIONS AS INDICATED ON PLANS)	
REMOVE POWER POLE/ LIGHT POLE	

SERVICES LEGEND	
ELECTRICITY (ENDEAVOUR ENERGY)	EE
NBN	NBN
TELSTRA	T
WATER	W
GAS	GAS
SEWER	S
STORMWATER	SW
FIBRE OPTIC (AARNET)	FO

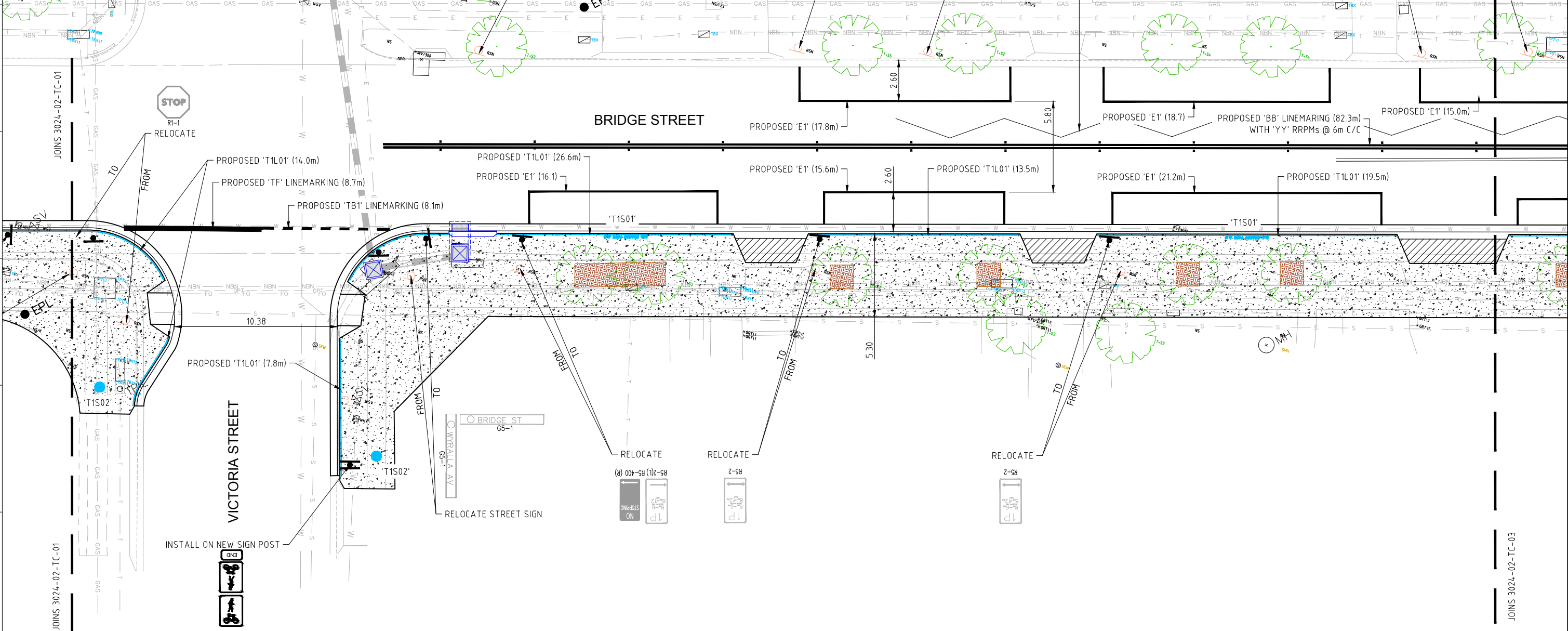

File location: z:\projects\3024\_pmc\eppping to carlingford active transport link\03 design\acad\working\2 bridge street\3024-02-sl (2) - copy.dwg

JOINS 3024-02-TC-03

JOINS 3024-02-TC-03

TRAFFIC COMMITTEE	BS	NP	12/02/20
No.	Revision	Revised on CAD do not amend by hand	Checked
			Approved
			Date
STATUS <b>TRAFFIC COMMITTEE</b>			

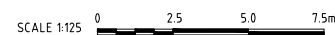

Copyright  
This document is & shall remain the property of Complete Urban Pty Ltd.  
The document may only be used for the purpose for which it was commissioned & in accordance with the terms of engagement for the commission. Unauthorised use of this document in any way is prohibited.



10 Regent Street  
Chippendale NSW 2008

p 02 9282 9900  
f 02 9282 9277

**COMPLETE**

ABN 64 100 037 812  
www.completeurban.com.au

Drawn	BS	Designed	BS
Drafting	NP	Design	NP
Check	NP	Check	NP
Approved			
<b>NOT FOR CONSTRUCTION</b>			
This Drawing must not be used for Construction unless signed as Approved			

Client and Job	CITY OF PARRAMATTA COUNCIL EPPING TO CARLINGFORD ACTIVE TRANSPORT LINK PROJECT 2- BRIDGE STREET, EPPING
Title	TRAFFIC COMMITTEE PLANS
	SHEET 02 OF 08
Drg. No.	3024-02-TC-02
Size	A1
Rev	--

GENERAL LEGEND	
CONCRETE FOOTPATH/ SHARED PATH	
CONCRETE KERB RAMP	
PLANTING AS SPECIFIED	
EXISTING TREE REMOVAL	
RETAIN EXISTING TREE	
CONCRETE K&G	
PROPOSED LINEMARKING	
CONCRETE DRIVEWAY	
REINSTATE ASPHALT PAVEMENT	
CONSTRUCT KERB INLET PIT/ JUNCTION PIT	
INSTALL STORMWATER PIPE (DIMENSIONS AS INDICATED ON PLANS)	
REMOVE POWER POLE/ LIGHT POLE	

SERVICES LEGEND	
ELECTRICITY (ENDEAVOUR ENERGY)	EE
NBN	NBN
TELSTRA	T
WATER	W
GAS	GAS
SEWER	S
STORMWATER	SW
FIBRE OPTIC (AARNET)	FO

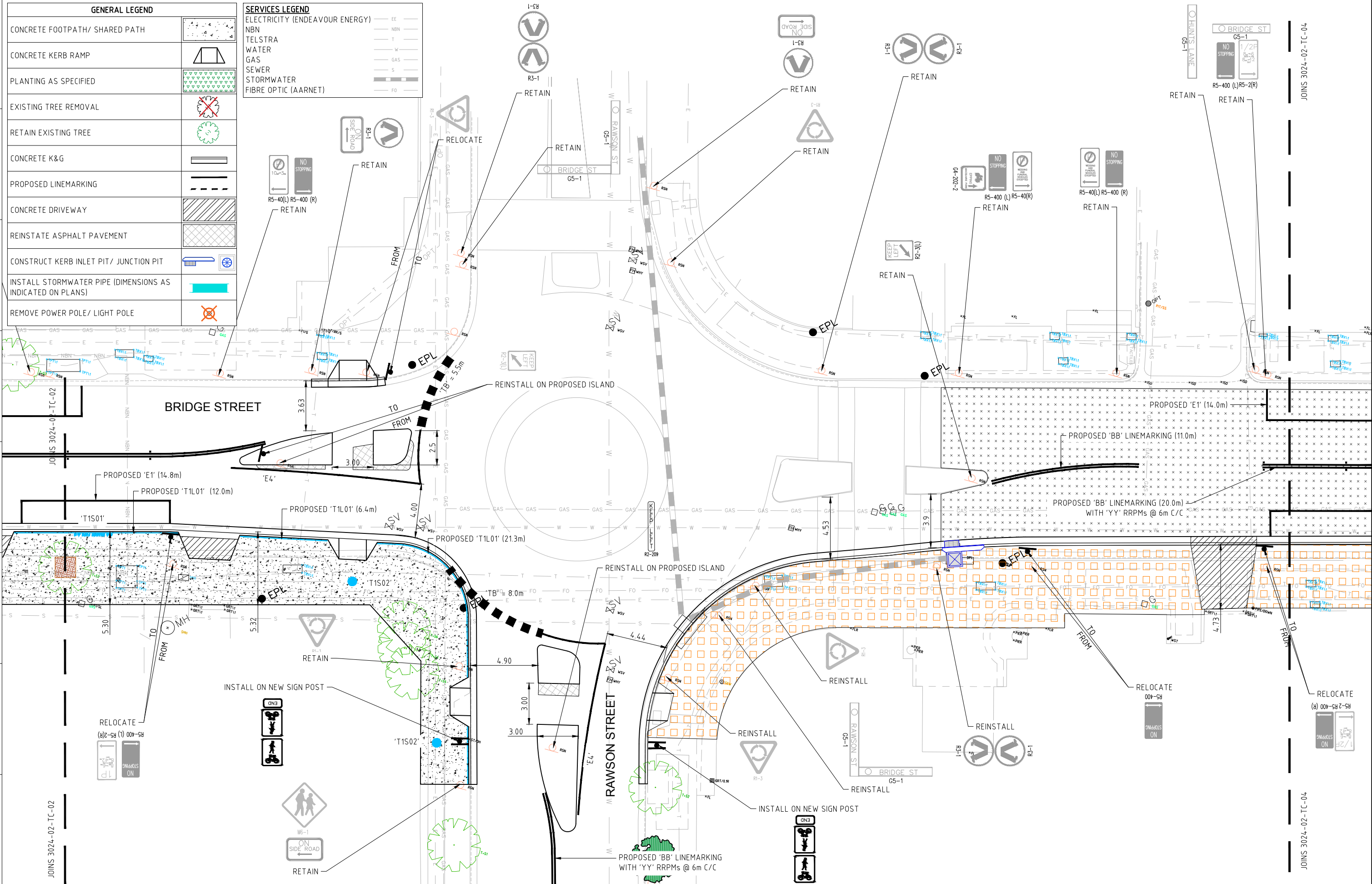

File location: z:\projects\3024\_pmc\_epping\_to\_carlingford\_active\_transport\link\03\_design\vacat\working\2\_bridge\_street\3024-02-sl (2) - copy.dwg

JOINS 3024-02-TC-02

JOINS 3024-02-TC-04

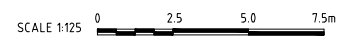

Copyright  
 This document is & shall remain the property of Complete Urban Pty Ltd.  
 The document may only be used for the purpose for which it was commissioned & in accordance with the terms of engagement for the commission. Unauthorised use of this document in any way is prohibited.



10 Regent Street  
 Chippendale NSW 2008

p 02 9282 9900  
 f 02 9282 9277

**COMPLETE**

ABN 64 100 037 812  
 www.completeurban.com.au

SCALE: 1:125 @A1	Client and Job
Drawn BS	Designed BS
Drafting Check NP	Design Check NP
Approved	
<b>NOT FOR CONSTRUCTION</b>	
This Drawing must not be used for Construction unless signed as Approved	

CITY OF PARRAMATTA COUNCIL  
 EPPING TO CARLINGFORD ACTIVE TRANSPORT LINK  
 PROJECT 2- BRIDGE STREET, EPPING  
 TRAFFIC COMMITTEE PLANS  
 SHEET 03 OF 08

DRG. NO. 3024-02-TC-03

No.	Revision	Revised by	Checked	Approved	Date	STATUS
					12/02/20	TRAFFIC COMMITTEE

Size	Rev
A1	--

GENERAL LEGEND	
CONCRETE FOOTPATH/ SHARED PATH	
CONCRETE KERB RAMP	
PLANTING AS SPECIFIED	
EXISTING TREE REMOVAL	
RETAIN EXISTING TREE	
CONCRETE K&G	
PROPOSED LINEMARKING	
CONCRETE DRIVEWAY	
REINSTATE ASPHALT PAVEMENT	
CONSTRUCT KERB INLET PIT/ JUNCTION PIT	
INSTALL STORMWATER PIPE (DIMENSIONS AS INDICATED ON PLANS)	
REMOVE POWER POLE/ LIGHT POLE	

SERVICES LEGEND	
ELECTRICITY (ENDEAVOUR ENERGY)	EE
NBN	NBN
TELSTRA	T
WATER	W
GAS	GAS
SEWER	S
STORMWATER	SW
FIBRE OPTIC (AARNET)	FO

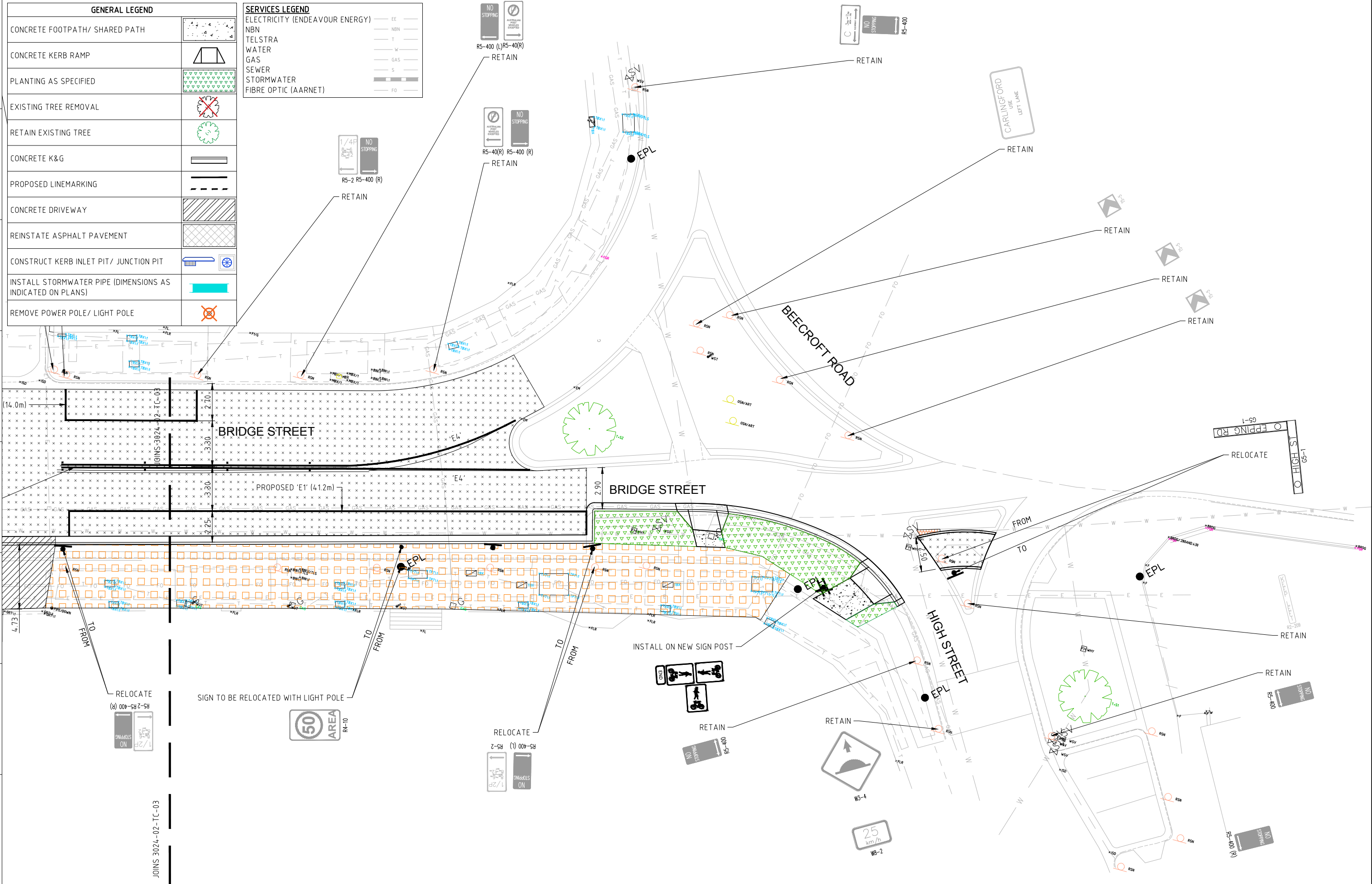

File location: z:\projects\3024\_pmc\_epping\_to\_carlingford\_active\_transport\link\03\_design\vacat\working\2\_bridge\_street\3024-02-sl (2) - copy.dwg

TRAFFIC COMMITTEE	BS	NP	12/02/20
No.	Revision	Revised on CAD do not amend by hand	Checked
TRAFFIC COMMITTEE		Approved	Date
STATUS <b>TRAFFIC COMMITTEE</b>			

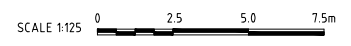

Copyright  
This document is & shall remain the property of Complete Urban Pty Ltd.  
The document may only be used for the purpose for which it was commissioned & in accordance with the terms of engagement for the commission. Unauthorised use of this document in any way is prohibited.

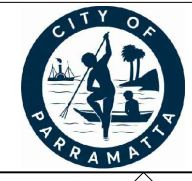

10 Regent Street  
Chippendale NSW 2008

p 02 9282 9900  
f 02 9282 9277

**COMPLETE**

ABN 64 100 037 812  
www.completeurban.com.au

SCALE: 1:125 @A1	
Drawn BS	Designed BS
Drafting Check NP	Design Check NP
Approved	
<b>NOT FOR CONSTRUCTION</b>	
This Drawing must not be used for Construction unless signed as Approved	

Client and Job  
**CITY OF PARRAMATTA COUNCIL  
EPPING TO CARLINGFORD ACTIVE TRANSPORT LINK  
PROJECT 2- BRIDGE STREET, EPPING**

Title  
**TRAFFIC COMMITTEE PLANS  
SHEET 04 OF 08**

Drg. No. 3024-02-TC-04

Size	A1
Rev	--

GENERAL LEGEND	
CONCRETE FOOTPATH/ SHARED PATH	
CONCRETE KERB RAMP	
PLANTING AS SPECIFIED	
EXISTING TREE REMOVAL	
RETAIN EXISTING TREE	
CONCRETE K&G	
PROPOSED LINEMARKING	
CONCRETE DRIVEWAY	
REINSTATE ASPHALT PAVEMENT	
CONSTRUCT KERB INLET PIT/ JUNCTION PIT	
INSTALL STORMWATER PIPE (DIMENSIONS AS INDICATED ON PLANS)	
REMOVE POWER POLE/ LIGHT POLE	

SERVICES LEGEND	
ELECTRICITY (ENDEAVOUR ENERGY)	EE
NBN	NBN
TELSTRA	T
WATER	W
GAS	GAS
SEWER	S
STORMWATER	SW
FIBRE OPTIC (AARNET)	FO

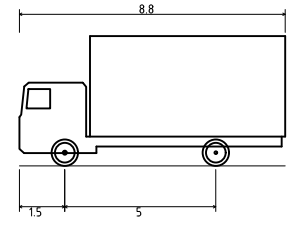

Service Vehicle (8.8 m)  
 Overall Length 8.800m  
 Overall Width 2.500m  
 Overall Body Height 4.300m  
 Min Body Ground Clearance 0.427m  
 Track Width 2.500m  
 Lock-to-lock time 4.00s  
 Curb to Curb Turning Radius 12.500m

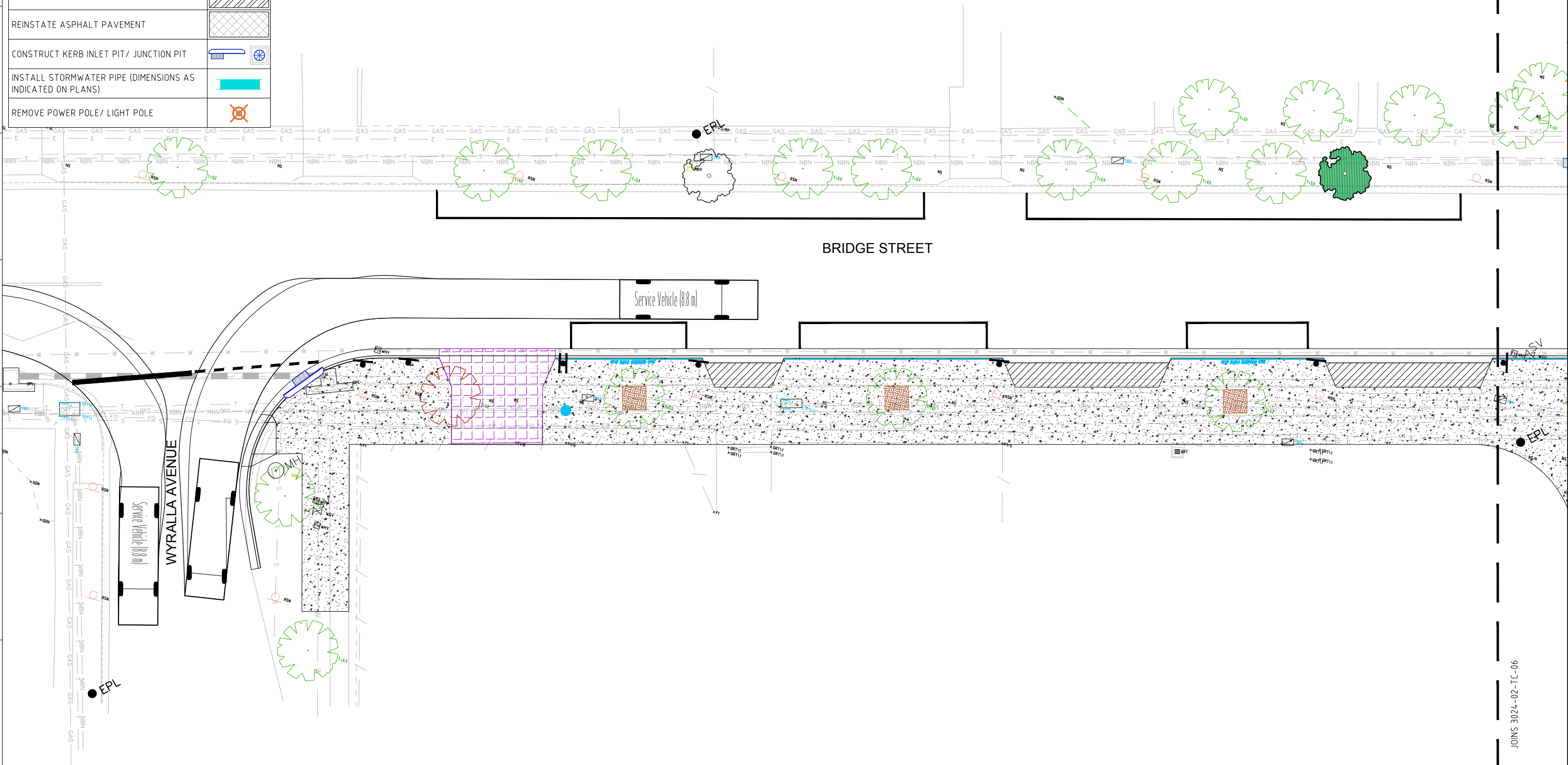

File location: z:\projects\3024\_pmc\_epping\_to\_carlingford\_active\_transport\link\03\_design\acad\working\2\_bridg\_street\3024-02-sl (2) - copy.dwg

JOINS 3024-02-TC-06

JOINS 3024-02-TC-06

No.	Revision	Revised by	Checked	Approved	Date
1	TRAFFIC COMMITTEE	BS	NP		12/02/20

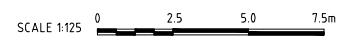

Copyright  
 This document is & shall remain the property of Complete Urban Pty Ltd.  
 The document may only be used for the purpose for which it was commissioned & in accordance with the terms of engagement for the commission. Unauthorised use of this document in any way is prohibited.



10 Regent Street  
 Chippendale NSW 2008  
 p 02 9282 9900  
 f 02 9282 9277

**COMPLETE**

ABN 64 100 037 812  
 www.completeurban.com.au

SCALE: 1:125 @A1	
Drawn BS	Designed BS
Drafting Check NP	Design Check NP
Approved	
<b>NOT FOR CONSTRUCTION</b>	
This Drawing must not be used for Construction unless signed as Approved	

Client and Job	CITY OF PARRAMATTA COUNCIL EPPING TO CARLINGFORD ACTIVE TRANSPORT LINK PROJECT 2- BRIDGE STREET, EPPING
Title	TRAFFIC COMMITTEE PLANS- SWEEP PATHS
	SHEET 05 OF 08
Drg. No.	3024-02-TC-05
Size	A1
Rev	--

GENERAL LEGEND	
CONCRETE FOOTPATH/ SHARED PATH	
CONCRETE KERB RAMP	
PLANTING AS SPECIFIED	
EXISTING TREE REMOVAL	
RETAIN EXISTING TREE	
CONCRETE K&G	
PROPOSED LINEMARKING	
CONCRETE DRIVEWAY	
REINSTATE ASPHALT PAVEMENT	
CONSTRUCT KERB INLET PIT/ JUNCTION PIT	
INSTALL STORMWATER PIPE (DIMENSIONS AS INDICATED ON PLANS)	
REMOVE POWER POLE/ LIGHT POLE	

SERVICES LEGEND	
ELECTRICITY (ENDEAVOUR ENERGY)	EE
NBN	NBN
TELSTRA	T
WATER	W
GAS	GAS
SEWER	S
STORMWATER	SW
FIBRE OPTIC (AARNET)	FO

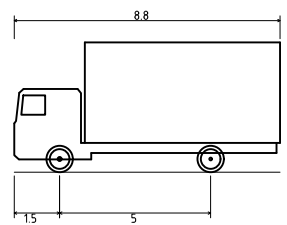

Service Vehicle (8.8 m)  
 Overall Length 8.800m  
 Overall Width 2.500m  
 Overall Body Height 4.300m  
 Min Body Ground Clearance 0.427m  
 Track Width 2.500m  
 Lock-to-lock time 4.00s  
 Curb to Curb Turning Radius 12.500m

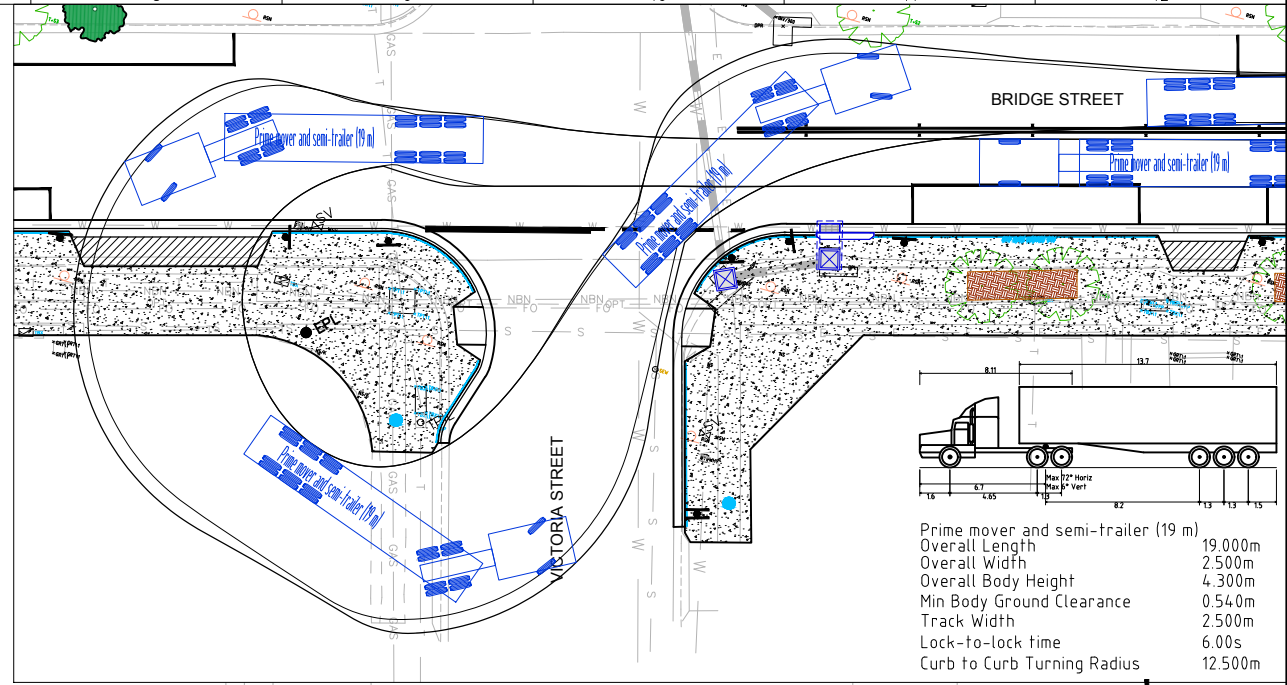

Prime mover and semi-trailer (19 m)  
 Overall Length 19.000m  
 Overall Width 2.500m  
 Overall Body Height 4.300m  
 Min Body Ground Clearance 0.540m  
 Track Width 2.500m  
 Lock-to-lock time 6.00s  
 Curb to Curb Turning Radius 12.500m

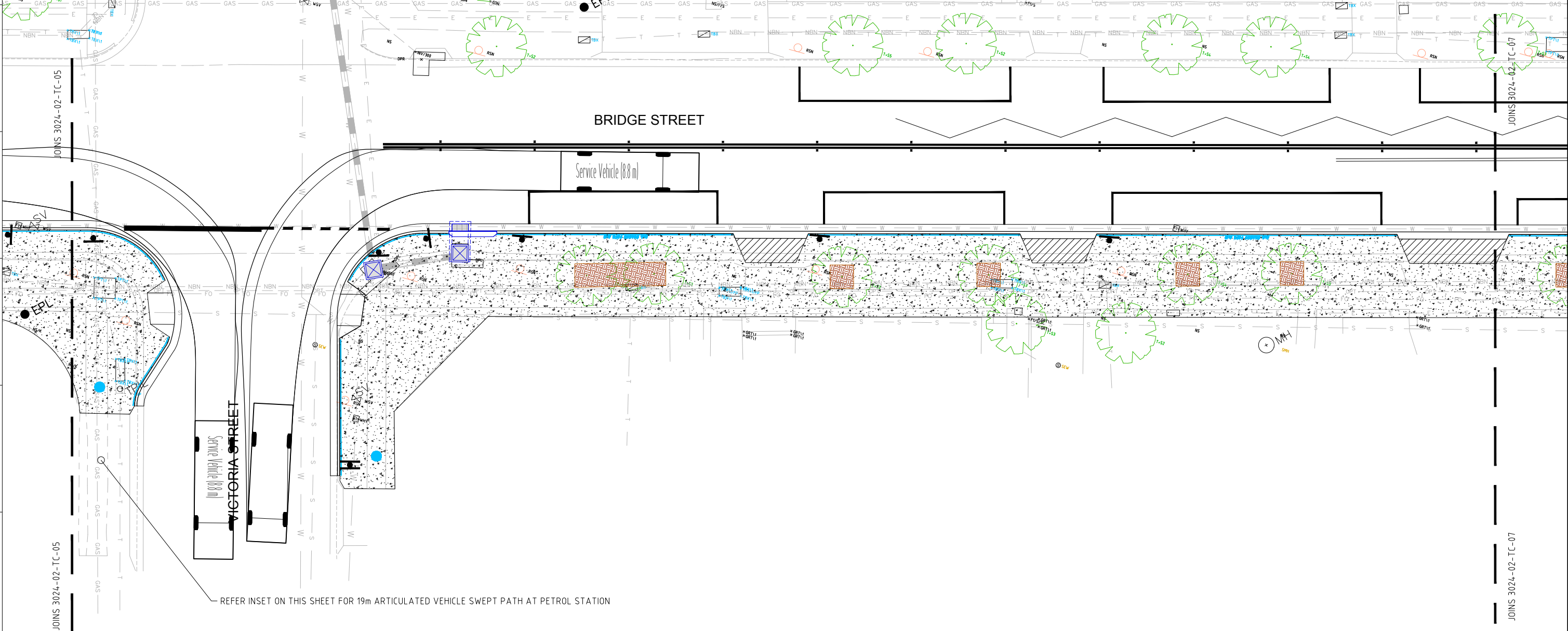

File location: z:\projects\3024 - pme epping to carlingford active transport link\03 design\acad\working\2\_bridgestreet\3024-02-sl (2) - copy.dwg

No.	Revision	Revised by	Checked	Approved	Date

SCALE 1:125

TRAFFIC COMMITTEE

Copyright  
 This document is & shall remain the property of Complete Urban Pty Ltd.  
 The document may only be used for the purpose for which it was commissioned & in accordance with the terms of engagement for the commission. Unauthorised use of this document in any way is prohibited.

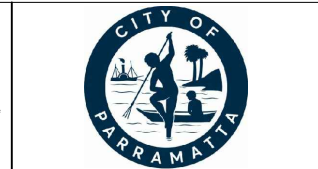

10 Regent Street  
 Chippendale NSW 2008 | p 02 9282 9900 | f 02 9282 9277

**COMPLETE**

ABN 64 100 037 812  
 www.completeurban.com.au

Drawn	BS	Designed	BS
Drafting Check	NP	Design Check	NP
Approved			

**NOT FOR CONSTRUCTION**

This Drawing must not be used for Construction unless signed as Approved

Client and Job	CITY OF PARRAMATTA COUNCIL EPPING TO CARLINGFORD ACTIVE TRANSPORT LINK PROJECT 2- BRIDGE STREET, EPPING
Title	TRAFFIC COMMITTEE PLANS- SWEEP PATHS SHEET 06 OF 08
Drg. No.	3024-02-TC-06
Size	A1
Rev	--

GENERAL LEGEND	
CONCRETE FOOTPATH/ SHARED PATH	
CONCRETE KERB RAMP	
PLANTING AS SPECIFIED	
EXISTING TREE REMOVAL	
RETAIN EXISTING TREE	
CONCRETE K&G	
PROPOSED LINEMARKING	
CONCRETE DRIVEWAY	
REINSTATE ASPHALT PAVEMENT	
CONSTRUCT KERB INLET PIT/ JUNCTION PIT	
INSTALL STORMWATER PIPE (DIMENSIONS AS INDICATED ON PLANS)	
REMOVE POWER POLE/ LIGHT POLE	

SERVICES LEGEND	
ELECTRICITY (ENDEAVOUR ENERGY)	EE
NBN	NBN
TELSTRA	T
WATER	W
GAS	GAS
SEWER	S
STORMWATER	SW
FIBRE OPTIC (AARNET)	FO

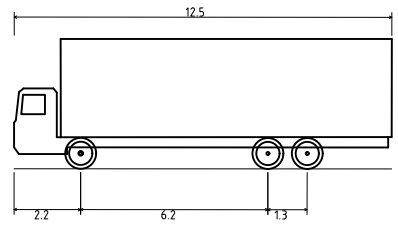

Single Unit Truck/Bus (12.5 m)  
 Overall Length 12.500m  
 Overall Width 2.500m  
 Overall Body Height 4.300m  
 Min Body Ground Clearance 0.490m  
 Track Width 2.500m  
 Lock-to-lock time 6.00s  
 Curb to Curb Turning Radius 12.500m

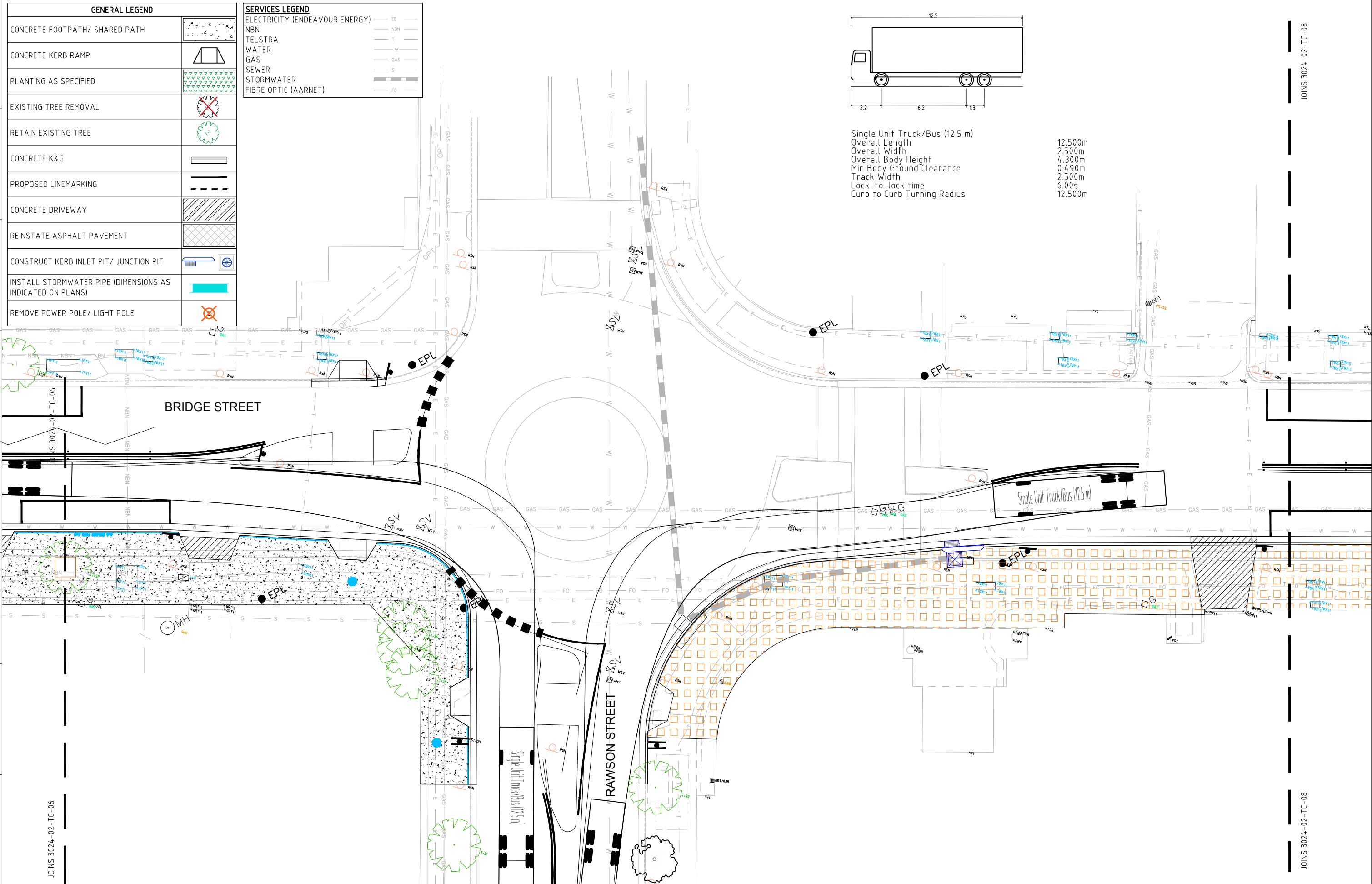

File location: z:\projects\3024\_pmc epping to carlingford active transport link\03 design\acad\working\2 bridge street\3024-02-sl (2) - copy.dwg

JOINS 3024-02-TC-06

JOINS 3024-02-TC-08

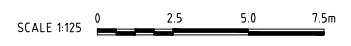

Copyright  
 This document is & shall remain the property of Complete Urban Pty Ltd.  
 The document may only be used for the purpose for which it was commissioned & in accordance with the terms of engagement for the commission. Unauthorised use of this document in any way is prohibited.



10 Regent Street  
 Chippendale NSW 2008  
 p 02 9282 9900  
 f 02 9282 9277

**COMPLETE**

ABN 64 100 037 812  
 www.completeurban.com.au

SCALE: 1:125 @A1

Drawn	BS	Designed	BS
Drafting Check	NP	Design Check	NP
Approved			

**NOT FOR CONSTRUCTION**  
 This Drawing must not be used for Construction unless signed as Approved

Client and Job  
 CITY OF PARRAMATTA COUNCIL  
 EPPING TO CARLINGFORD ACTIVE TRANSPORT LINK  
 PROJECT 2- BRIDGE STREET, EPPING  
 Title  
 TRAFFIC COMMITTEE PLANS- SWEEP PATHS  
 SHEET 07 OF 08

Drg. No. 3024-02-TC-07  
 No. 3024-02-TC-08

No.	Revision	Revised by	Checked	Approved	Date	Status
					12/02/20	TRAFFIC COMMITTEE

Scale A1  
 Rev --



GENERAL LEGEND	
CONCRETE FOOTPATH/ SHARED PATH	
CONCRETE KERB RAMP	
PLANTING AS SPECIFIED	
EXISTING TREE REMOVAL	
RETAIN EXISTING TREE	
CONCRETE K&G	
PROPOSED LINEMARKING	
CONCRETE DRIVEWAY	
REINSTATE ASPHALT PAVEMENT	
CONSTRUCT KERB INLET PIT/ JUNCTION PIT	
INSTALL STORMWATER PIPE (DIMENSIONS AS INDICATED ON PLANS)	
REMOVE POWER POLE/ LIGHT POLE	

SERVICES LEGEND	
ELECTRICITY (ENDEAVOUR ENERGY)	EE
NBN	NBN
TELSTRA	T
WATER	W
GAS	GAS
SEWER	S
STORMWATER	SW
FIBRE OPTIC (AARNET)	FO

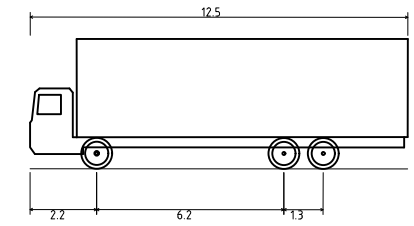

Single Unit Truck/Bus (12.5 m)  
 Overall Length 12.500m  
 Overall Width 2.500m  
 Overall Body Height 4.300m  
 Min Body Ground Clearance 0.490m  
 Track Width 2.500m  
 Lock-to-lock time 6.00s  
 Curb to Curb Turning Radius 12.500m

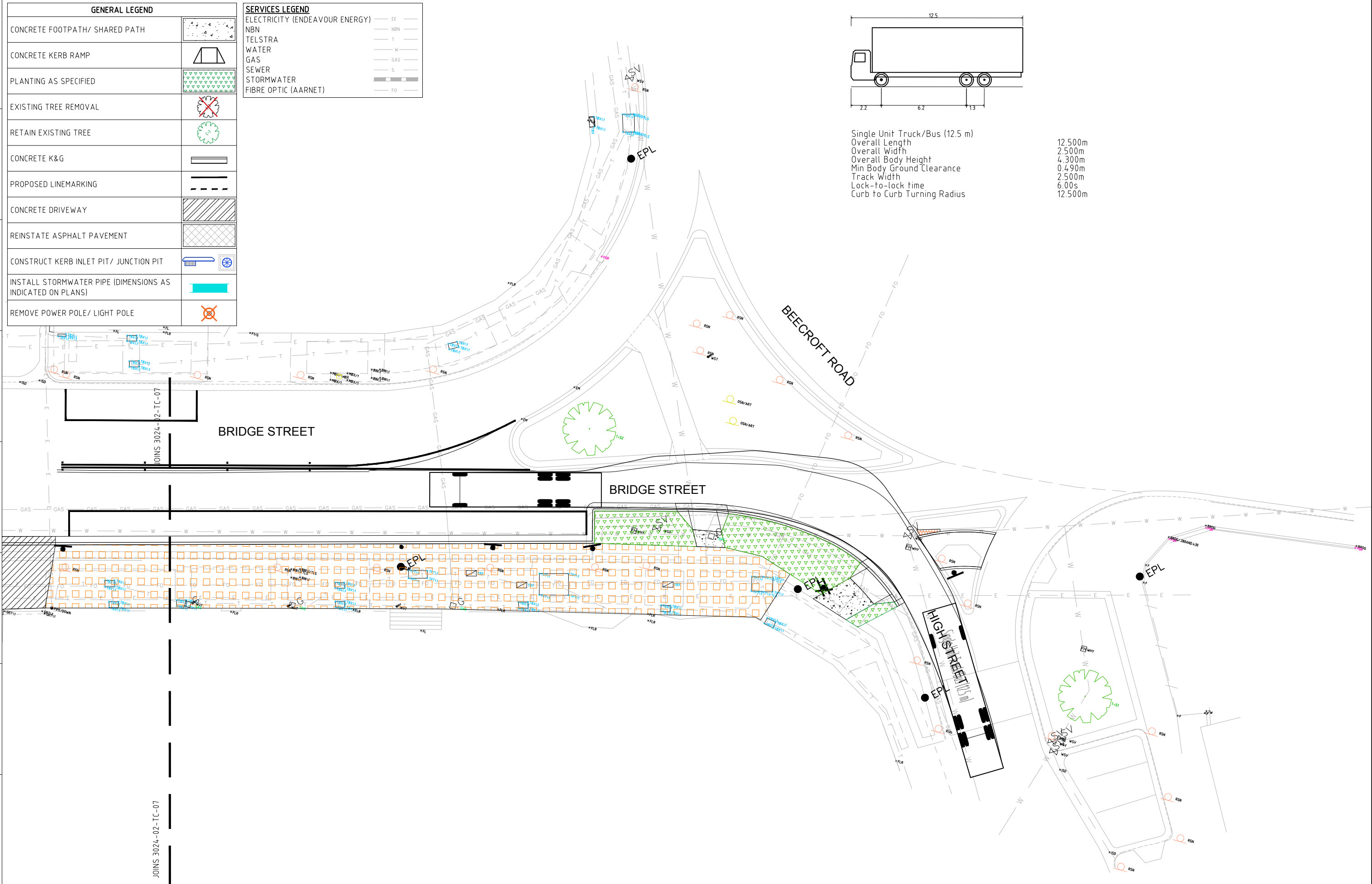

File location: z:\projects\3024\_pmc\_epping\_to\_carlingford\_active\_transport\link\03\_design\acad\working\2\_bridge\_street\3024-02-sl (2) - copy.dwg

No.	Revision	Checked	Approved	Date	STATUS
1	TRAFFIC COMMITTEE	BS	NP	12/02/20	TRAFFIC COMMITTEE

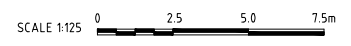

Copyright  
 This document is & shall remain the property of Complete Urban Pty Ltd.  
 The document may only be used for the purpose for which it was commissioned & in accordance with the terms of engagement for the commission. Unauthorised use of this document in any way is prohibited.

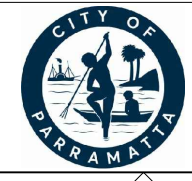

10 Regent Street  
 Chippendale NSW 2008

p 02 9282 9900  
 f 02 9282 9277

**COMPLETE**

ABN 64 100 037 812  
 www.completeurban.com.au

Drawn	BS	Designed	BS
Drafting	NP	Design	NP
Check	NP	Check	NP
Approved			

Client and Job  
 CITY OF PARRAMATTA COUNCIL  
 EPPING TO CARLINGFORD ACTIVE TRANSPORT LINK  
 PROJECT 2- BRIDGE STREET, EPPING

Title  
 TRAFFIC COMMITTEE PLANS- SWEEP PATHS  
 SHEET 08 OF 08

**NOT FOR CONSTRUCTION**  
 This Drawing must not be used for Construction unless signed as Approved

Drg. No.	3024-02-TC-08	Size	A1	Rev	--
----------	---------------	------	----	-----	----